

NEW

Dimensions in mm

MultiPlus 24V/48V 5kVA
 Phoenix Inverter 24V/48V 5kVA
 Quattro 24V/48V 5kVA

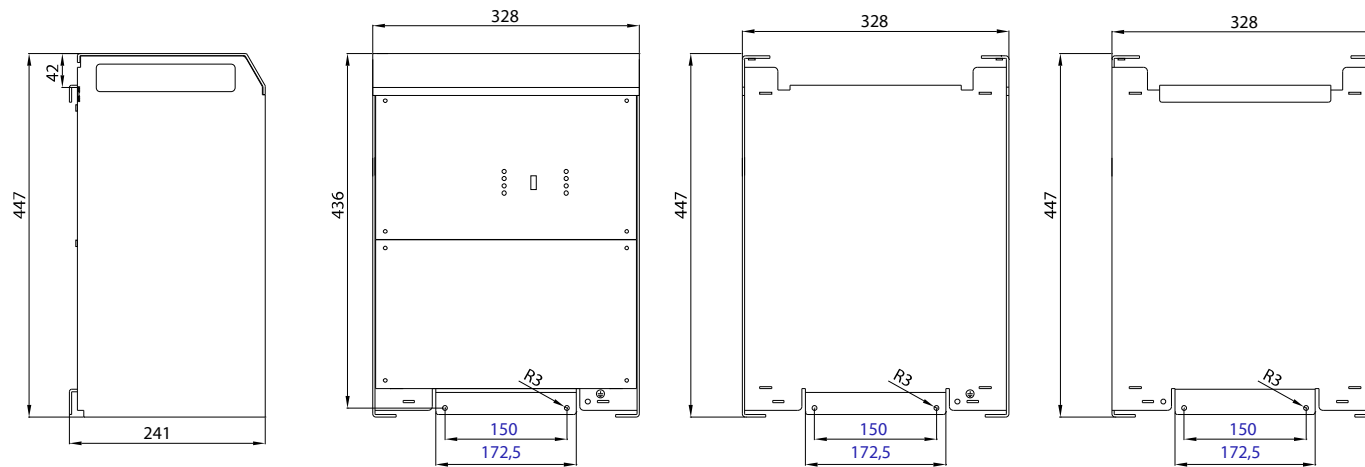
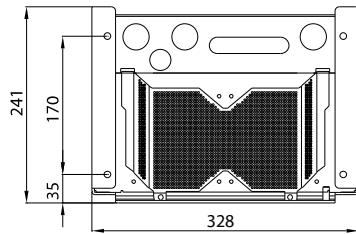

OLD

Dimensions in mm

MultiPlus 24V/48V 5kVA
 Phoenix Inverter 24V/48V 5kVA
 Quattro 24V/48V 5kVA

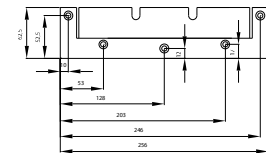
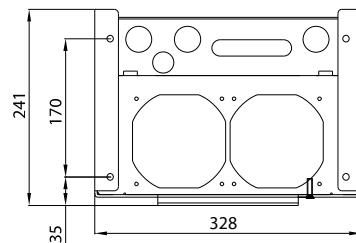

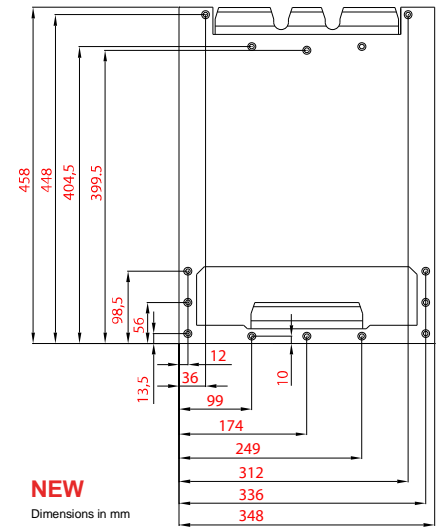
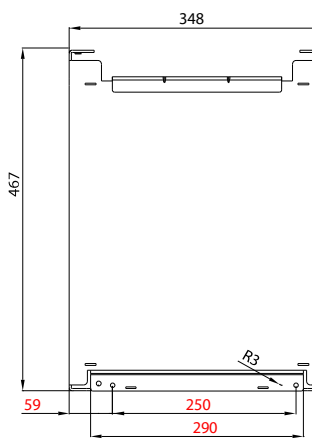
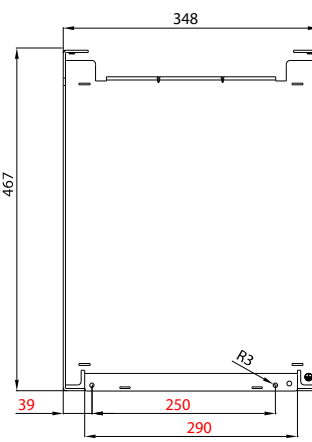
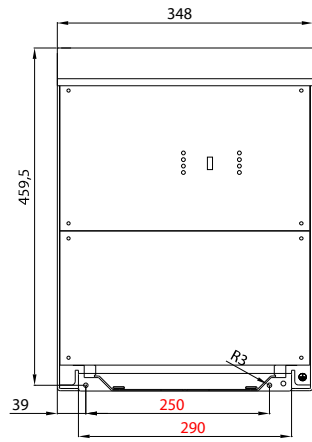
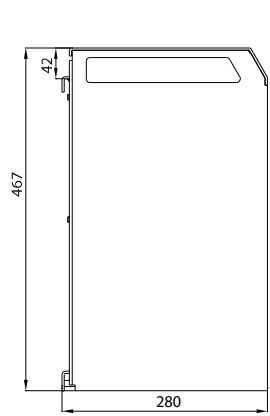

NEW

Dimensions in mm

Quattro 12V 5kVA
 Quattro 24V 8kVA, 48V 8/10kVA

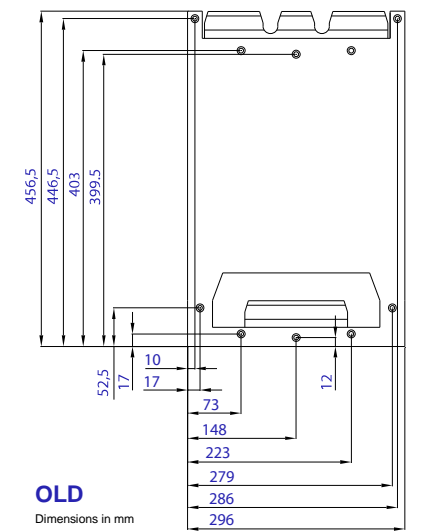
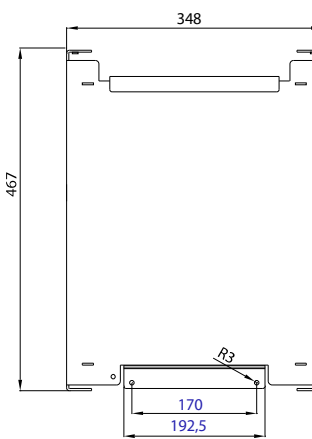
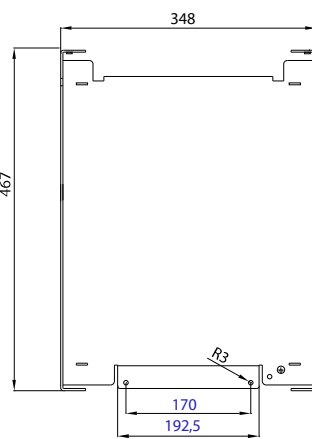
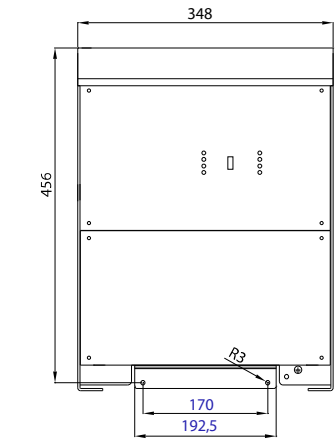
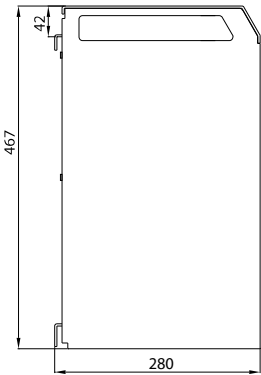
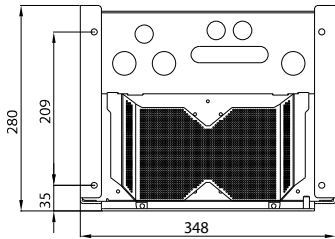

OLD

Dimensions in mm

Quattro 12V-5kVA
 Quattro 24V-8kVA, 48V-8/10kVA

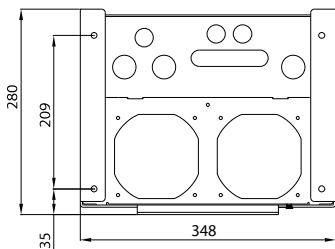

OLD

Dimensions in mm

Wall mounting plate
 Quattro 12V-5kVA
 Quattro 24V-8kVA, 48V-8/10kVA

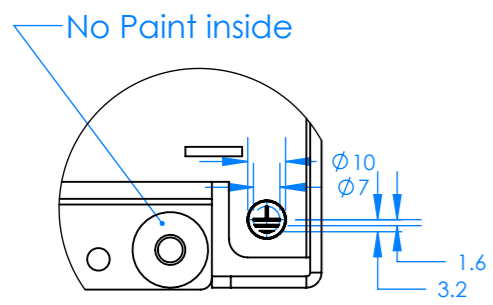

DETAIL A
emboss PE symbol
SCALE 1 : 2

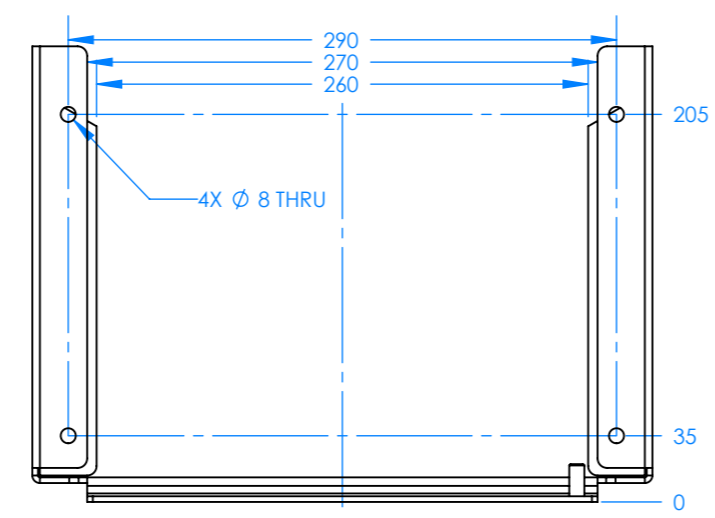
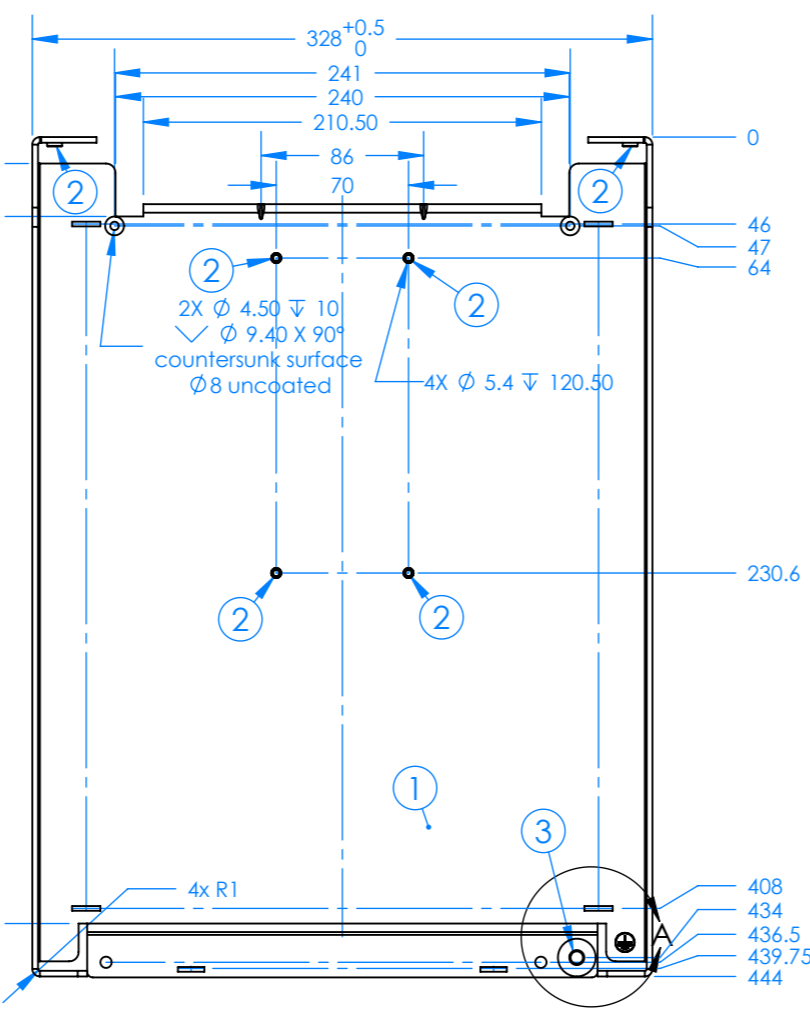
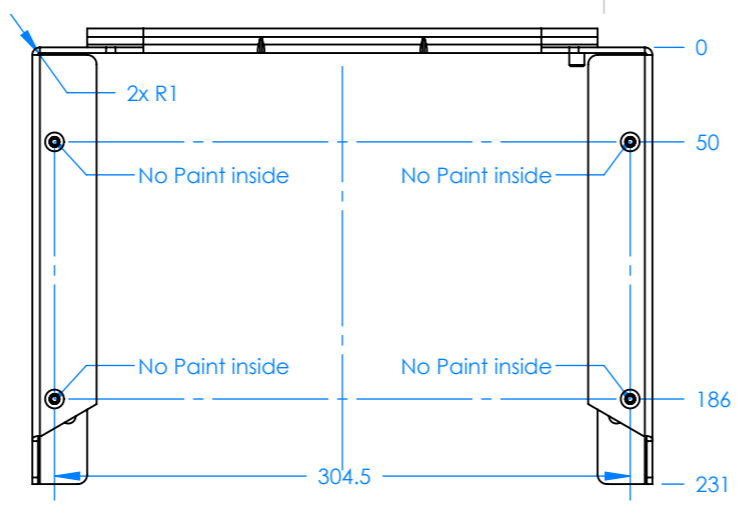

ITEM NO.	DESCRIPTION	PartNumber	QTY.
1	5kVA case	HOU170001023	1
2	PEM clinchnut	PEM S-M4-2-ZI	8
3	PEM selfclinching stud	PEM HFHB-M8-20	1

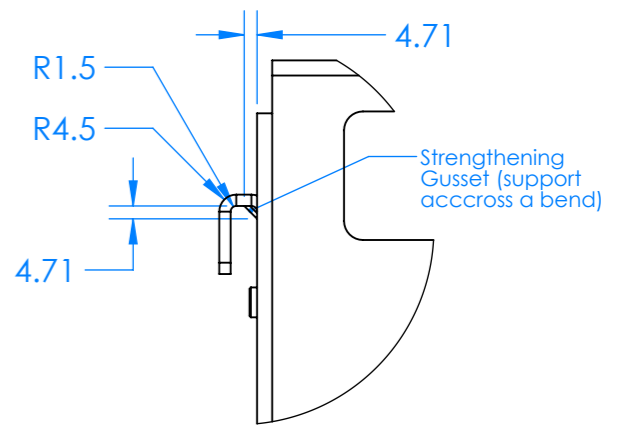

DETAIL C
SCALE 1 : 2

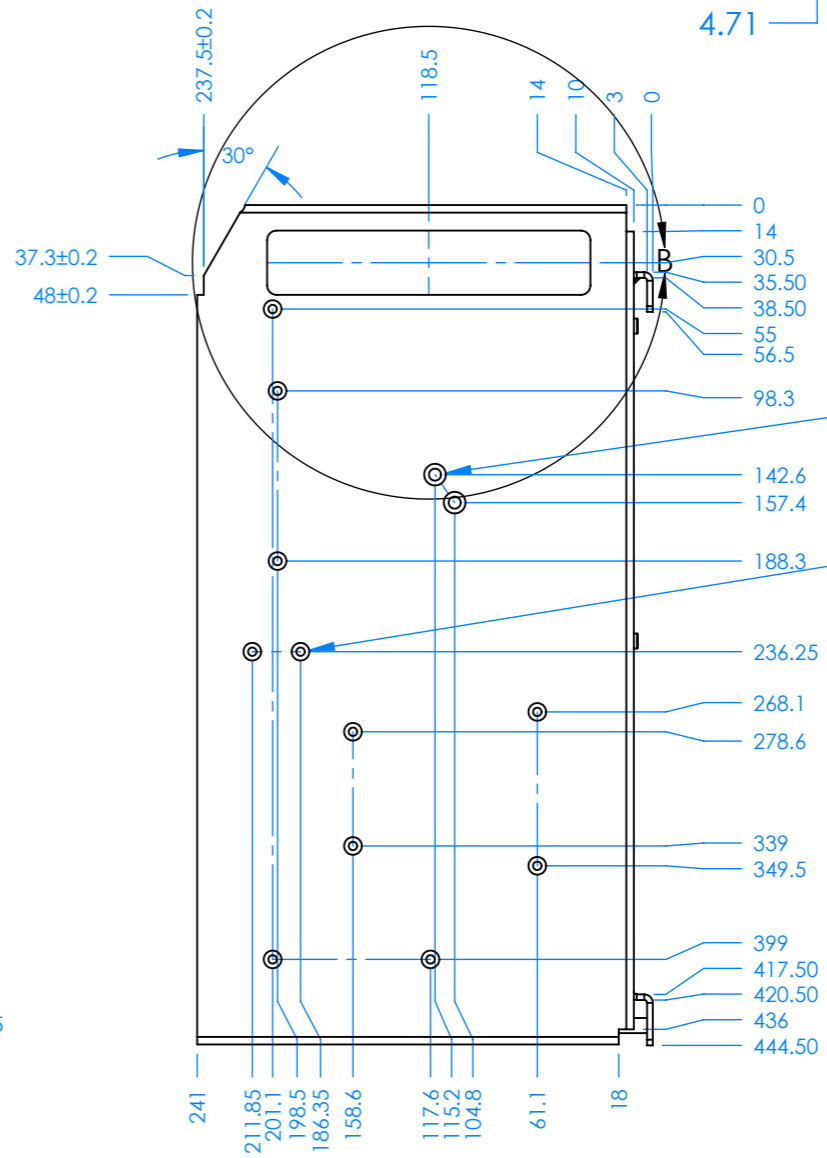

2X Ø 6.40 ∇ 10
 \surd Ø 11.50 X 90°
 countersunk surface
 Ø11.5 uncoated

11X Ø 4.50 THRU
 \surd Ø 9.40 X 90°
 countersunk surface
 Ø8 uncoated
 inside case Ø10
 uncoated

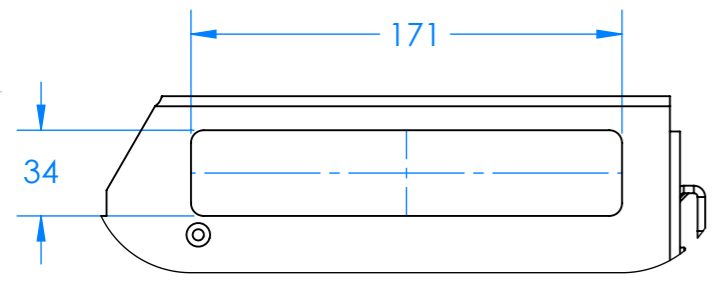
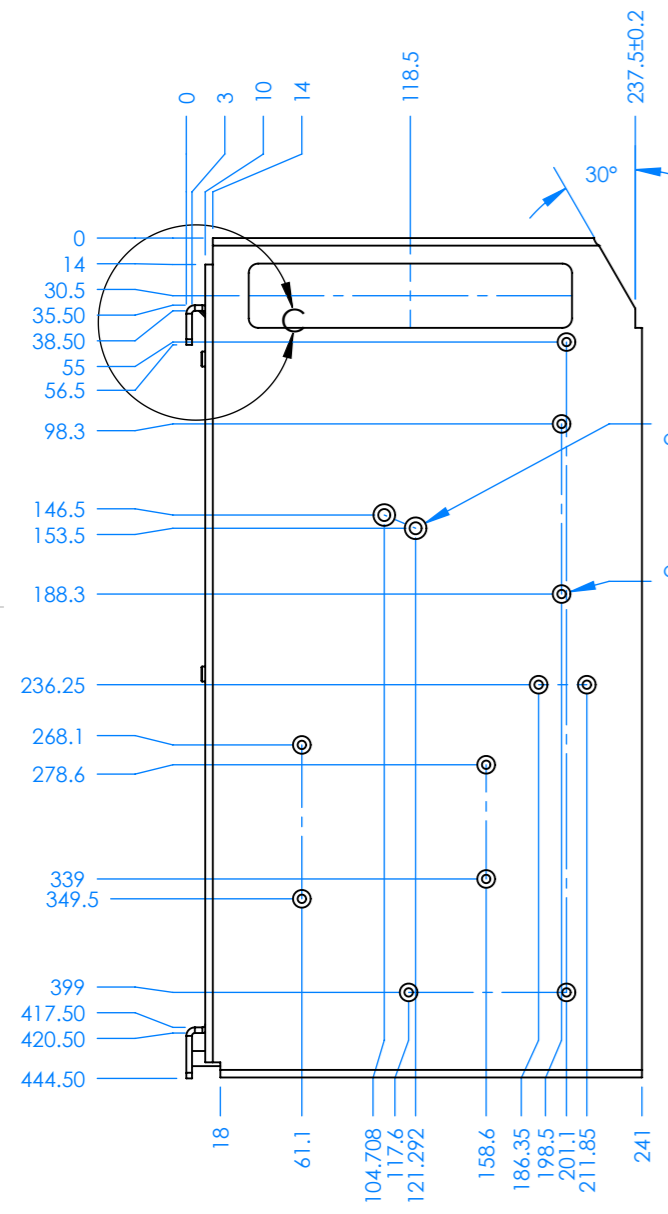
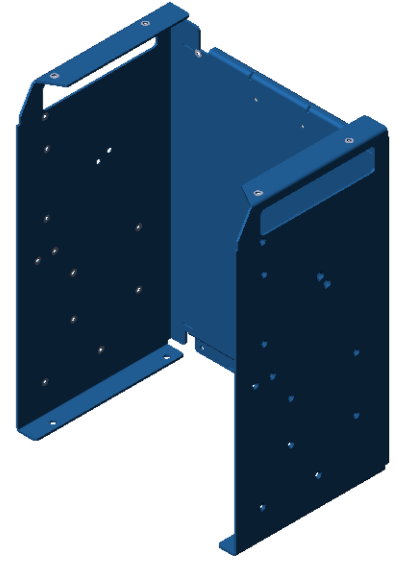

DETAIL B
SCALE 1 : 3

Remarks: Tolerance ISO 2768 class m unless stated otherwise Tolerance on hole positions ±0.1 All dimensions in mm		FINISH: Coating as specified in "Quality Requirements for Cabinet Material"		DEBUR AND BREAK SHARP EDGES		DO NOT SCALE DRAWING		REVISION 13	
DRAWN LH		SIGNATURE		DATE 22-Dec-14		USA projection			
CHK'D		APPV'D		MFG		Q.A		TITLE: 5kVA case	
MATERIAL: Al 99.5 3[mm]		WEIGHT:		DWG NO. HOU170001023		SCALE:1:4		SHEET 1 OF 1	
Victron Energy								A3	

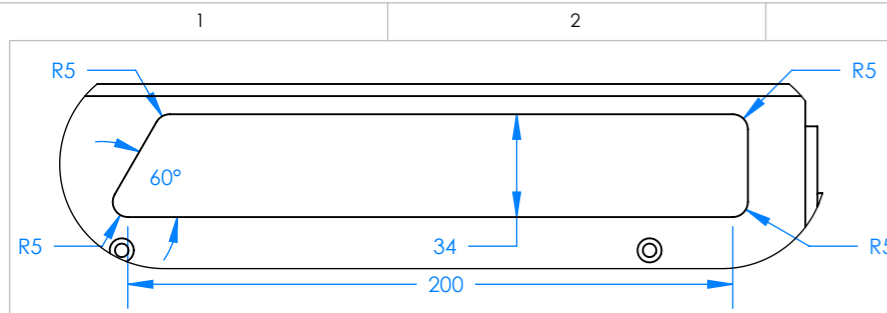

DETAIL A
SCALE 2 : 5

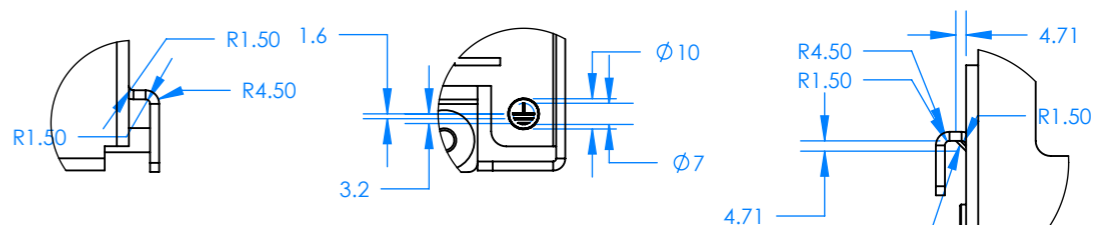
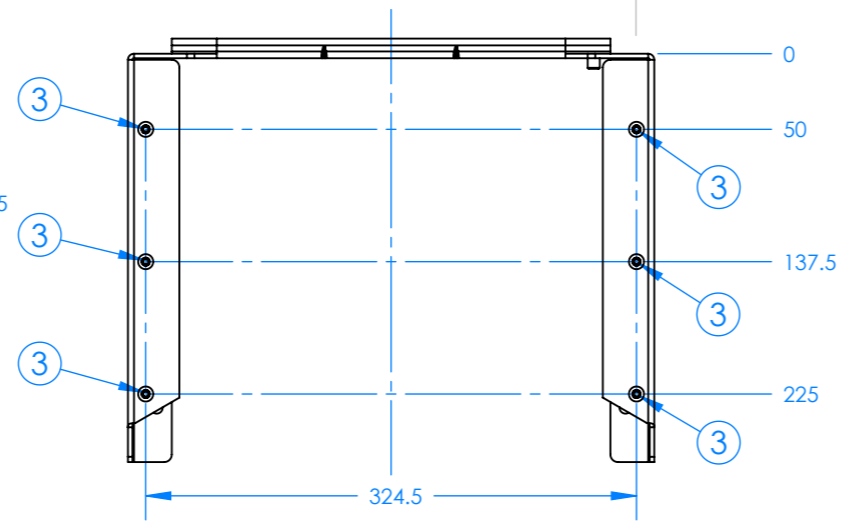

DETAIL B
SCALE 2 : 5

DETAIL C
emboss PE symbol
SCALE 2 : 5

DETAIL D
SCALE 2 : 5

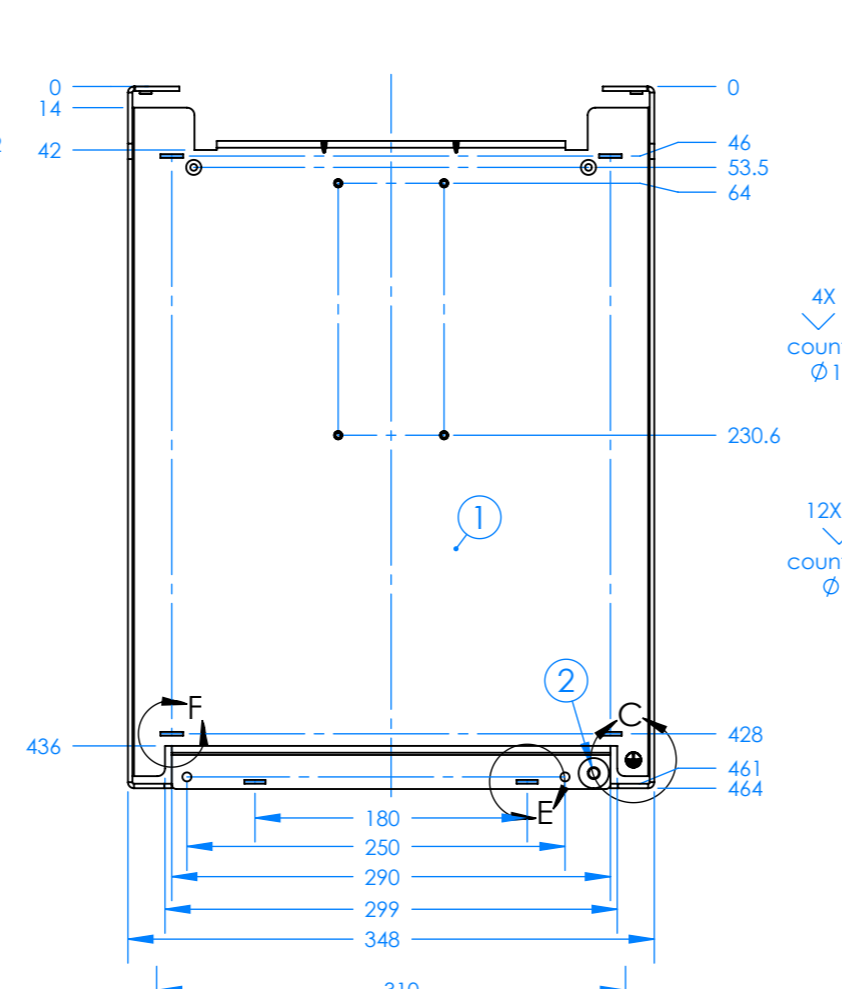
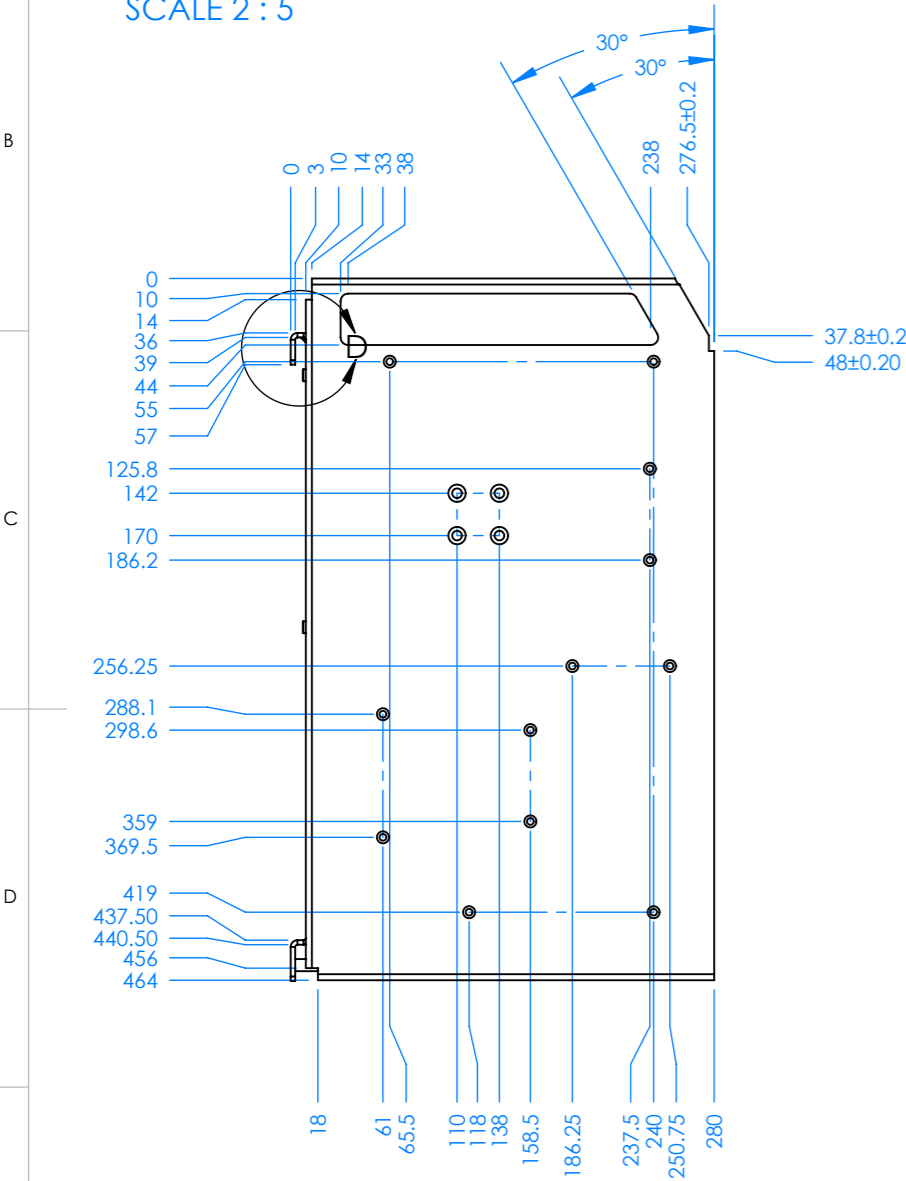

4X Ø 6.40 ∇ 10
∇ Ø 11.50 X 90°
countersunk surface
Ø11.5 uncoated

12X Ø 4.50 ∇ 10
∇ Ø 8 X 90°
countersunk surface
Ø8 uncoated

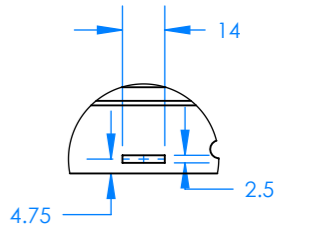
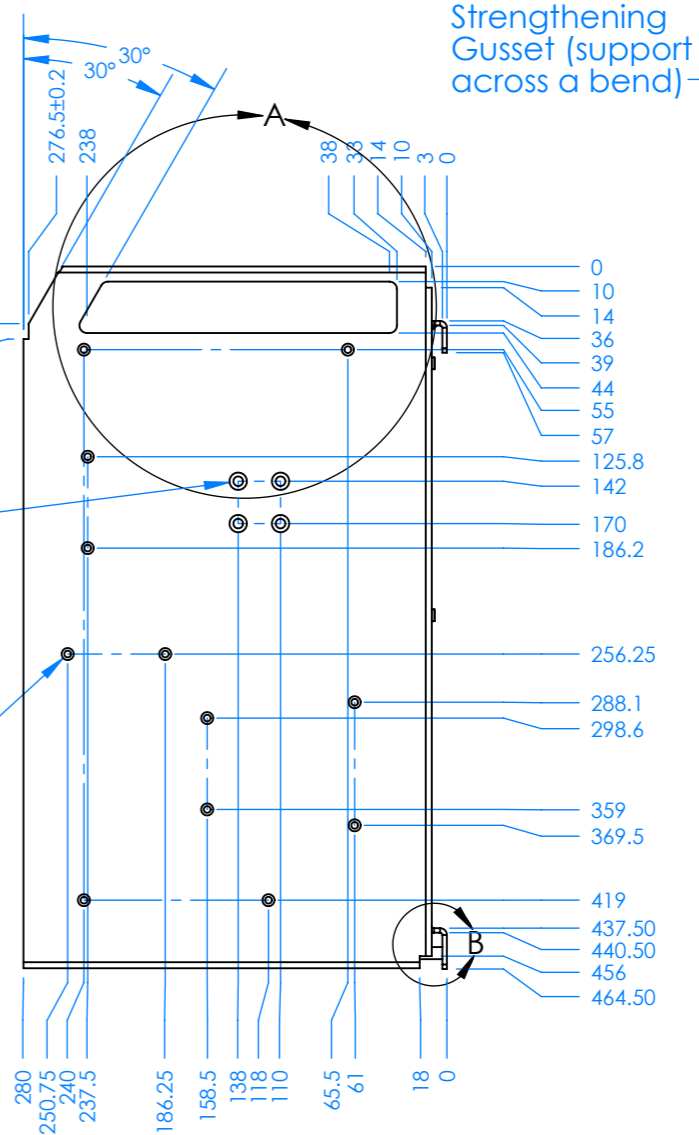

DETAIL E
2x (14x2,5[mm])
SCALE 2 : 5

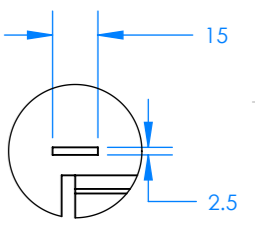

DETAIL F
4x (15x2,5[mm])
SCALE 2 : 5



32x no coating Ø10

REMARKS:
-inside bending radius R1
-all roundings R5
-debur edges

ITEM NO.	DESCRIPTION	PartNumber	QTY.
1	10kVA case	HOU2100001013	1
2	PEM selfclinchng stud	PEM HFHBM820	1
3	PEM clinchnut	PEM S-M4-2-ZI	10

Remarks: Tolerance ISO 2768 class m unless stated otherwise
Tolerance on hole positions ±0.1
All dimensions in mm

FINISH: Coating as specified in "Quality Requirements for Cabinet Material"

DEBUR AND BREAK SHARP EDGES

DO NOT SCALE DRAWING

REVISION 3

USA projection

TITLE: 10kVA case

DWG NO. HOU2100001013

SCALE:1:5

SHEET 1 OF 1

A3

MATERIAL: Al 99.5 3[mm]

WEIGHT:

Victron Energy

NAME: LH, SIGNATURE, DATE: 16-12-14

24-48V 5000VA	
PIN245020000	Phoenix Inverter 24/5000 230V VE.Bus
PIN485020000	Phoenix Inverter 48/5000 230V VE.Bus
QUA245021010	Quattro 24/5000/120-100/100 230V VE.Bus
QUA245023110	Quattro 24/5000/120-100/100 120V VE.Bus
QUA485021010	Quattro 48/5000/70-100/100 230V VE.Bus
QUA485021100	Quattro 48/5000/70-100/100 120V VE.Bus
PMP245021100	MultiPlus 24/5000/120-100 230V VE.Bus
PMP485021010	MultiPlus 48/5000/70-100 230V VE.Bus

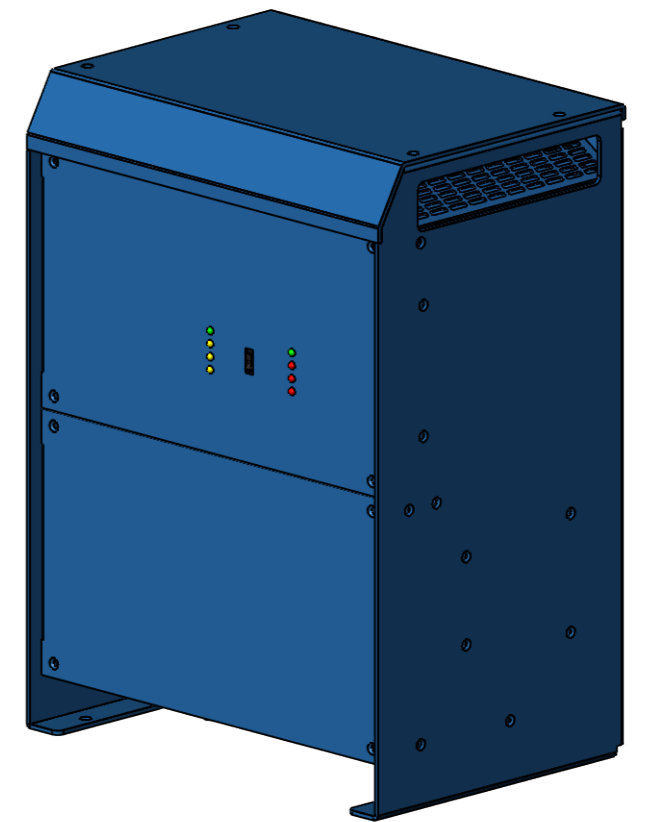
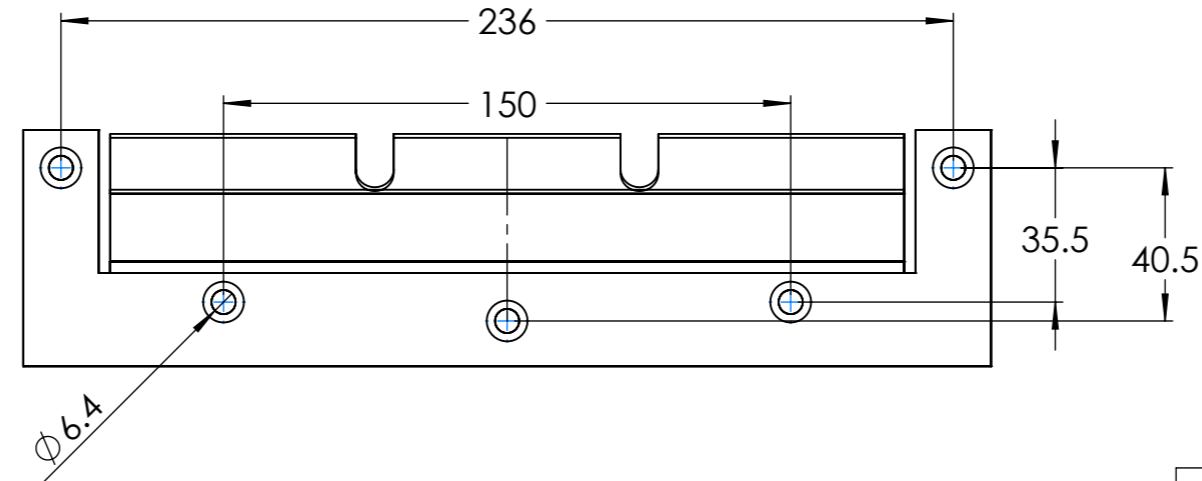
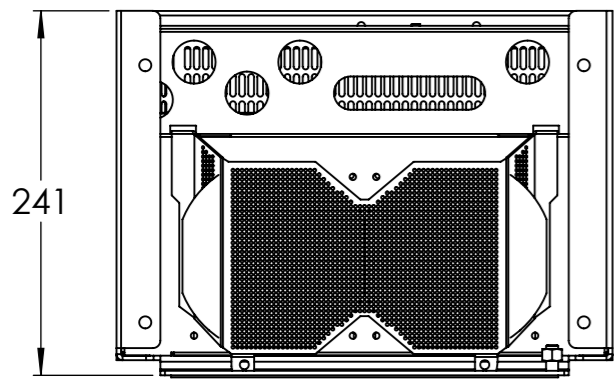
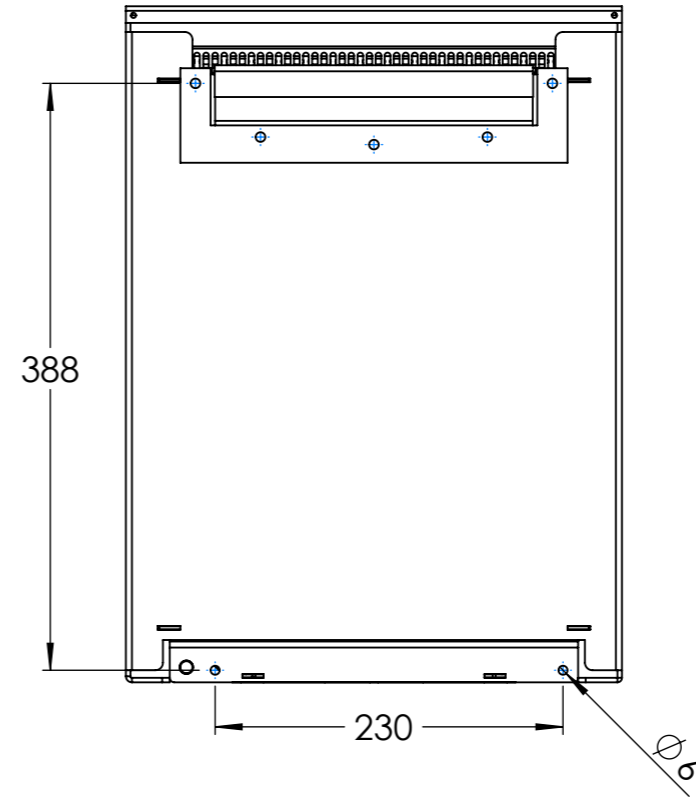
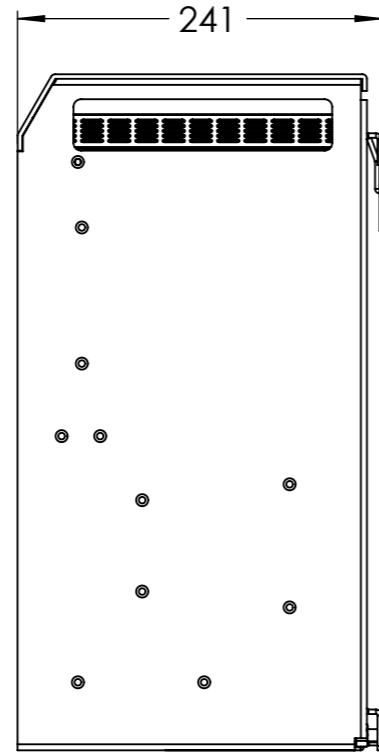
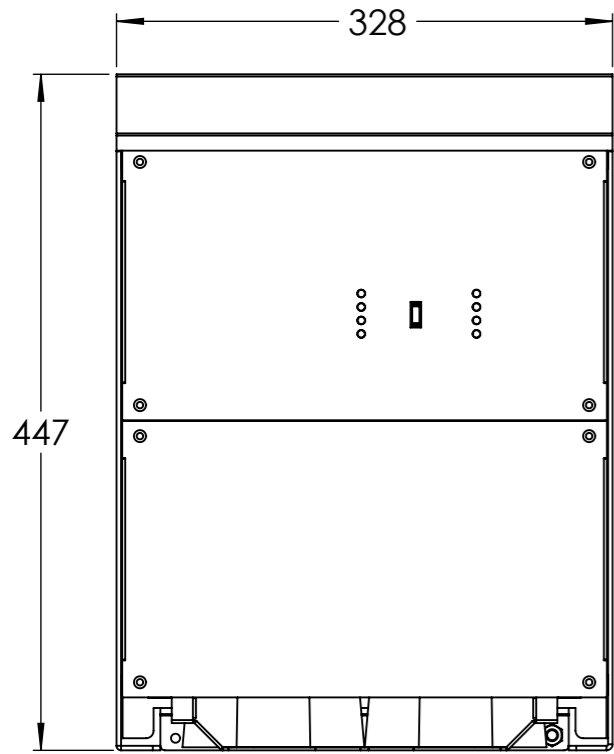

Dimensions in mm



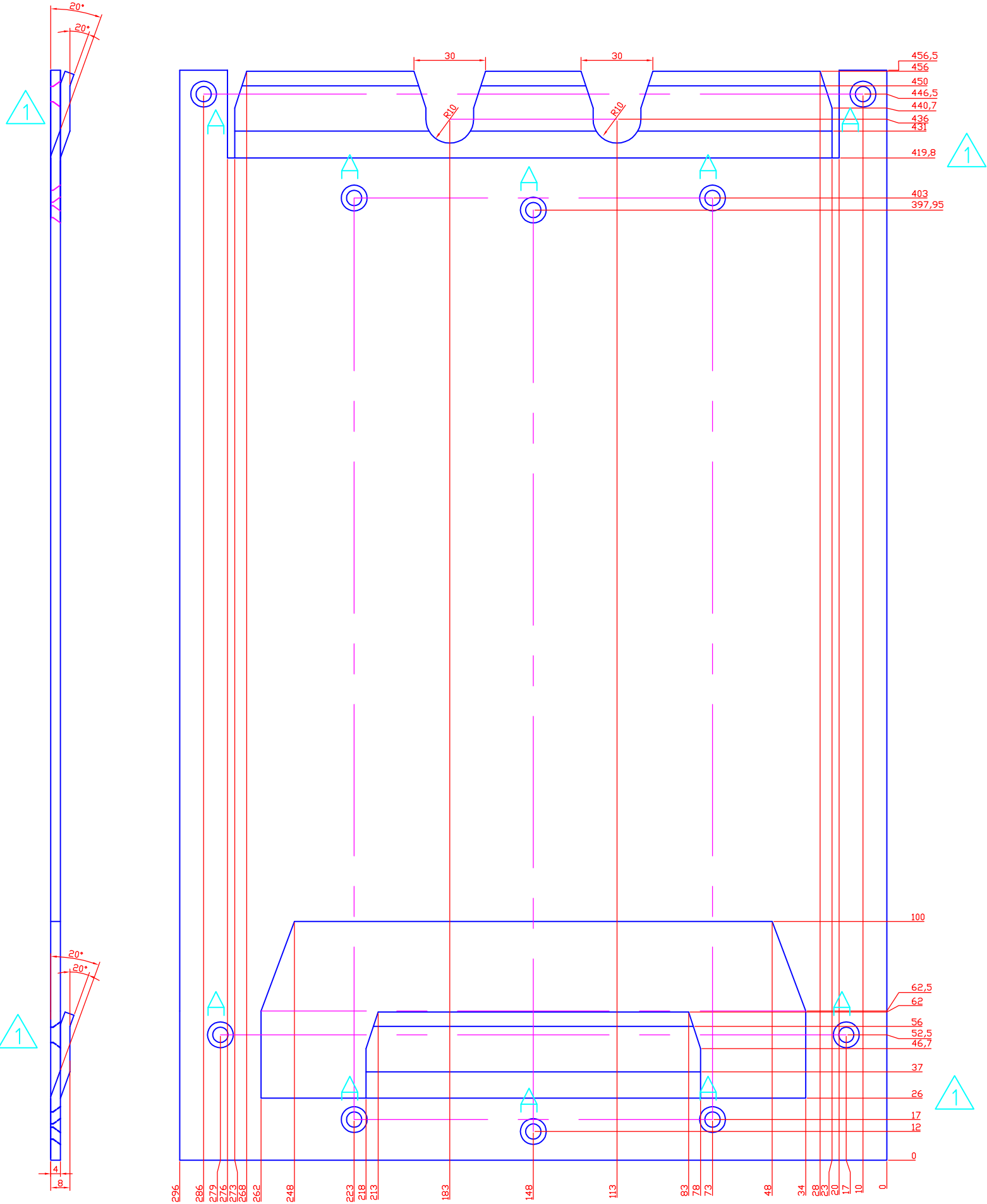

Rev.	Description	Date	By	Check
00	First Release	12-Aug-09	LH	---
01	bend out changed slightly	17-Mar-10	LH	---



REMARKS
 -deburr edges
 -material Al99.5 4mm
 -coating as specified in "Quality Requirements for Cabinet Material"

detail qua. spec.
 A 10 CSK(10.8x6.4-5NOS)

01	---	---	---
Itemno.	Quantity	Description	Article No./Reference
Title: Mounting Plate			 USA projection
Drawing: HOU210009011			
 Victron Energy		Remarks: Tolerance ISO 2768 class m unless stated otherwise All dimensions in mm	Size: A3 Scale: 1:2 Sheet: 1/1 Rev.: 01

Rev.	Description	Date	By	Check
00	First Release	12-Aug-09	LH	LH
01	bend out changed slightly	17-Mar-10	LH	LH
02	made bigger for new case with fire enclosure	25-Feb-15	LH	---

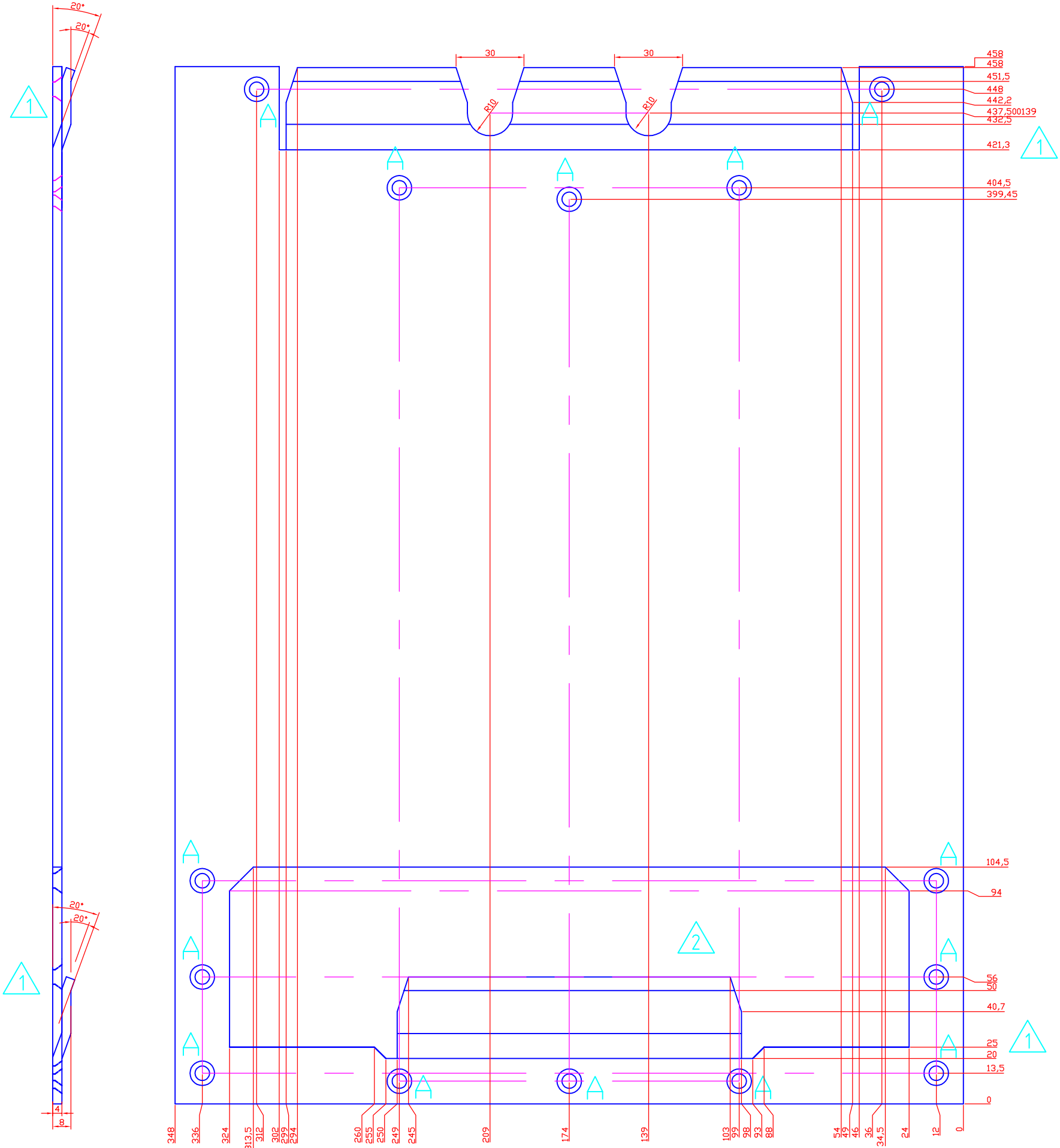

REMARKS
 -deburr edges
 -material Al99.5 4mm
 -coating as specified in "Quality Requirements for Cabinet Material"

detail qua. spec.
 A 14 CSK(10.8x6.4-5NOS)

Itemno.	Quantity	Description	Article No./Reference
01	---	---	---

Title: **Mounting Plate**

Drawing: **HOU210009012**

Victron Energy

Remarks:
 Tolerance ISO 2768 class m unless stated otherwise
 All dimensions in mm

USA projection

Size: A3 Scale: 1:2
 Sheet: 1/1 Rev.: 02

