

**Aqua-Magic®**  
Residence, Style Plus, Lite & II  
Nozzle Kit

FIGURE 1

**Kit Contains**

- Nozzle
- Clamp (PN 19541)
- Nozzle nut (PN 19761)
- Nozzle gasket (PN 19736)
- Flush hose (PN 34377)
- Closet flange seal (PN 02125)

**Needed**

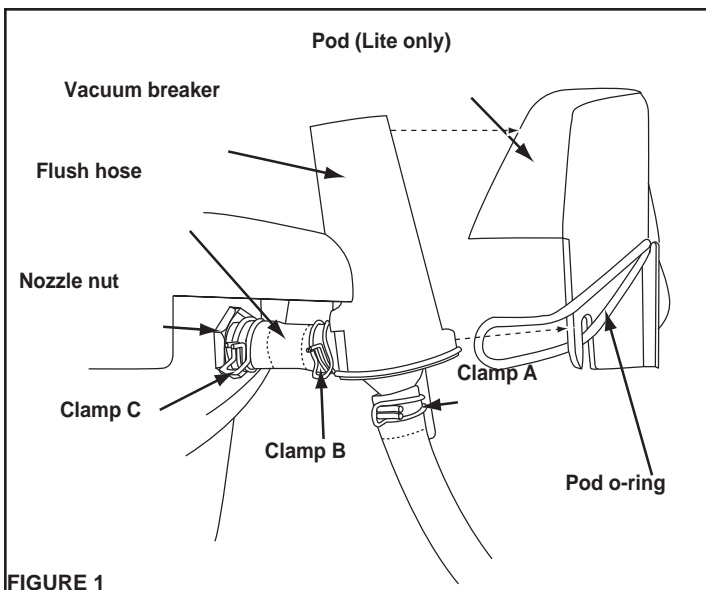
- Towel(s)
- Plastic trash bag
- Channel lock pliers
- Needle Nose pliers
- 1/2-inch wrench

**Before Beginning**

- Read all instructions completely.
- Reduce holding tank odor: Rinse toilet with water, drain holding tank, and add Thetford Holding Tank Deodorant.
- Wear protective gloves, glasses, long sleeves, and nose/face mask to avoid contact with human waste.
- Wash entire toilet thoroughly.
- Refer to Figures 1 and 2 for component locations.

**Remove Toilet**

1. Turn off RV water supply per RV Owner's Manual.
2. Flush toilet to drain.
3. Style Plus only - Remove shroud:
  - a. Unhook two O-rings holding Shroud together in back of toilet.
  - b. Holding down pedal, spread shroud apart while pulling it forward and off.
4. Place towel(s) behind toilet under water connection to catch water.
5. Disconnect RV water supply from toilet.
6. Remove Closet Flange Bolt Covers (if present) and Nuts.
7. Lift Toilet from floor and place on trash bag.
8. Cover holding tank opening with a towel.
9. Remove old closet flange Seal. Discard.

## ENGLISH

### Remove Old Nozzle

1. Style Lite - Remove pod:
  - a. Remove pod o-ring.
  - b. Remove pod
2. Slide clamp B forward on flush hose, then remove the vacuum breaker.
3. Remove clamps B and C from flush hose, then remove flush hose from nozzle.
4. Remove nozzle nut with pliers. Discard.
5. Remove nozzle and gasket and discard.

### Install New Nozzle

1. Install new gasket onto nozzle.
2. Install new nozzle onto bowl.
3. Install new nozzle nut while keeping nozzle aligned as shown in Figure 2.
4. Install new flush hose on nozzle, then secure with new clamp C.
5. Slide old clamp B up flush hose.
6. Install vacuum breaker on flush hose, then secure with clamp B.
7. *Style Lite* - Install pod.
  - a. Install pod.
  - b. Install pod o-ring.

### Reinstall Toilet

1. Install new Closet Flange Seal, lip side down, on toilet.
2. Uncover holding tank opening and remove towel(s).
3. Place Toilet on floor, aligning mounting holes with closet bolts.
4. Tighten Closet Flange Nuts until toilet does not rock. *Do not overtighten.*
5. Replace Bolt Covers (if present).
6. Connect RV water supply line to Toilet.
7. *Style Plus only* – Install Shroud.
  - a. Spread Shroud open, then lower pedal opening over pedal neck.
  - b. Wrap Shroud around to back of toilet. Push pedal down, then push shroud into place to engage front fastening device.
  - c. Secure back of Shroud with two O-rings – larger on top and smaller on bottom.
8. Turn on RV water supply.
9. Flush test Toilet, checking for leaks at all connections

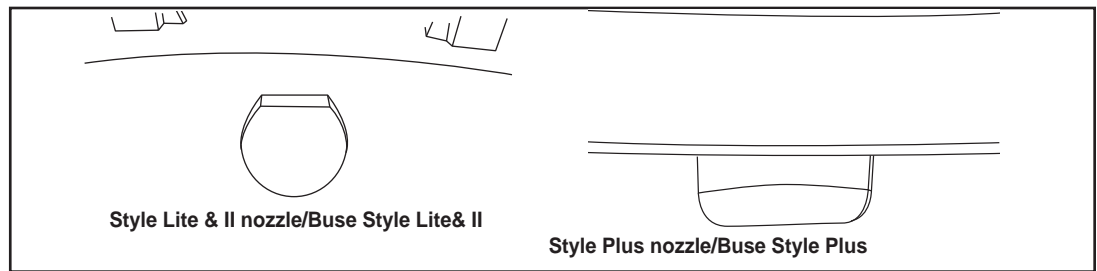

FIGURE 2. NOZZLES