

Starfrit



ELECTRIC MANDOLINE

INSTRUCTIONS FOR USE AND CARE

General description

1. Cubing blade A
2. Cubing blade B
3. Grater
4. Slicing blades
5. Julienne blades
6. Slicing and julienne blade
7. 1l-cup bowl
8. Cleaning brush
9. Cube cleaner
10. Food pusher
11. Lid
12. Removable protection tray
13. Base

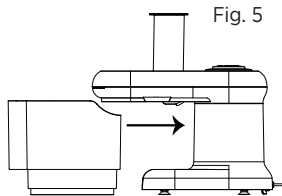
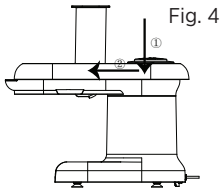
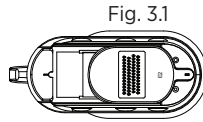
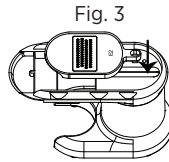
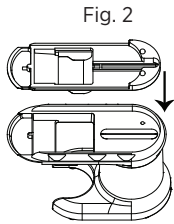
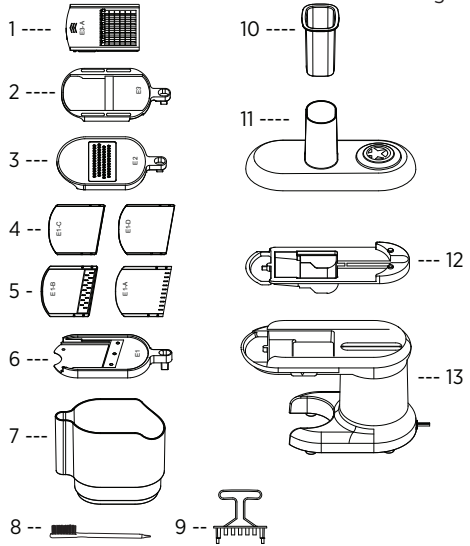

Blades assemble

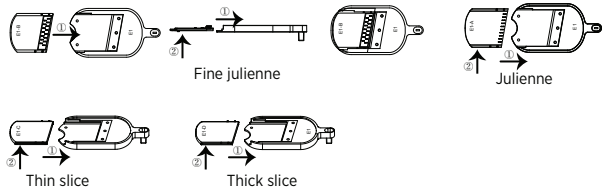
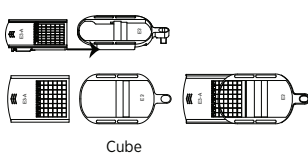

OPERATING AND SAFETY INSTRUCTIONS

Item no.	Voltage (V)	Wattage (W)	Frequency (Hz)
024210	120	150	60

IMPORTANT SAFEGUARDS

READ THE BELOW INSTRUCTIONS BEFORE USE

WARNING: To reduce the risk of fire, electrical shock, serious personal injury and/or property damage:

1. To protect against electric shock, do not immerse, power cord, plug or product in water or expose to other liquids.
2. Keep the appliance out of the reach of children and pets. This product is not intended for use by children. Close adult supervision is necessary when any appliance is used near children. Do not leave the product unattended while it is in use.
3. Do not operate the product if it has a damaged power cord or plug, or after the appliance malfunctions or has been damaged in any manner. Do not attempt to examine or repair this product yourself. Please call the customer service number provided in this user manual.
4. Always unplug the appliance from the electrical outlet when not in use, before changing parts, cleaning or moving the appliance. To disconnect, switch control to OFF "O." Pull directly on the plug - do not pull on the power cord.
5. Do not plug or unplug the product into/from the electrical outlet with wet hands.
6. The blades are sharp; handle with care.
7. Do not use attachments not recommended or not sold by the product manufacturer.
8. This product is intended for indoor, non-commercial use. Do not use outdoors or for any other purpose.
9. Do not allow the power cord to hang (e.g., over the edge of a table or counter) or touch hot surfaces.
10. Do not place the product on or near a hot gas or electric burner, or in heated oven or microwave oven.
11. Always use the electric mandoline on a flat, level, stable surface.
12. Connect the power plug to an easily accessible outlet so that the appliance can be unplugged immediately in the event of an emergency.
13. Do not use the appliance for anything other than its intended use.
14. Do not attempt to slice food by hand.
15. Always use the provided food pusher to push the food down the chute. Never use utensils or your fingers to insert the food. Always use the provided parts & accessories to avoid injuries.

16. **Do not operate the appliance for more than 1 minute and 30 seconds continuously and keep at least 2 minutes between cycles. Turn OFF the appliance when removing/placing food on the food pusher.**
17. Do not use as meat grinder or ice crusher

SAVE THESE INSTRUCTIONS FOR FUTURE REFERENCE

POLARIZED PLUG: This appliance is equipped with a polarized plug (one blade is wider than the other). As a safety feature to reduce the risk of electrical shock, this plug is intended to fit in a polarized outlet only one way. If the plug does not fit fully in the outlet, reverse the plug. If it still does not fit, contact a qualified electrician. Do not attempt to defeat this feature or modify the plug in any way. If the plug fits loosely into the AC outlet or if the AC outlet feels warm, do not use that outlet.

SPECIAL INSTRUCTIONS: A short power supply cord is provided to reduce the risk of becoming entangled in or tripping over a longer cord.

AN EXTENSION CORD MAY BE USED IF CARE IS EXERCISED IN THEIR USE:

- Minimize the risk of overheating by using the shortest UL or ETL listed cord possible.
- The marked electrical rating must be at least as great as that of the product.
- Never use a single extension cord to operate more than one appliance.
- Arrange the longer cord so that it will not drape over a countertop or tabletop where it can be tripped over, snagged, or pulled on unintentionally (especially by children).
- DO NOT alter the plug. DO NOT attempt to defeat the safety purpose of the polarized plug.

BEFORE FIRST USE

WARNING: Blades are sharp, handle with care. Do not plug the appliance into an electrical outlet before it's ready to be used.

NOTE: Remove all parts & accessories and dispose of packaging.

1. Wash all parts & accessories in hot soapy water and dry thoroughly or place in the dishwasher.
2. Wipe the motorized base with a damp cloth and dry thoroughly.

TO ASSEMBLE

WARNING: Blades are sharp, handle with care

1. First, insert the removable protection tray into the appliance. (P.2 Fig.2)
2. Insert the selected blade into the blade holding gear. Make sure it fits flat. (P.2 Fig.3 and Fig.3.1)
3. Place the lid on the base and pull towards the food container until you hear a snap. (P.2 Fig.4)

CAUTION: The mandoline has a locking mechanism that prevents the blade from moving if the lid is not securely locked or the blade is not inserted properly.

4. Place the food container to collect the processed food. (P.2 Fig.5)

CAUTION: The mandoline has a locking mechanism that prevents the blade from moving if the food container is not inserted properly.

TO USE

WARNING: Blades are sharp, handle with care, you must handle with care. Never use fingers or utensils to push down the food, always use the food pusher provided

1. Assemble the mandoline and put it on a stable surface. (P.2 Fig.1)

NOTE: Refer to the TO ASSEMBLE section

2. Prep the vegetables/fruits by cutting the ends.
3. Insert the selected blade into the base, on top of the removable protection tray. (P.2 Fig.6)

CAUTION: The mandoline has a locking mechanism that prevents the blade from working if the lid/food container is not securely locked or the blade is not inserted properly.

4. Put the lid over the removable protection tray and the food container in place. (P.2 Fig.4 and Fig.5)
5. Plug the power cord into a standard 120-volt AC electrical outlet.
6. Place the food in the food chute.

NOTE: If the food does not fit in the food chute, cut it in half or trim around to get the perfect size.

7. Insert the food pusher in the food chute.
8. Press the power button and start pushing the food down by applying gentle constant pressure.

9. When done processing the vegetable/fruit/cheese stop pressing on the power button.
10. Collect the processed food in the cup.

WARNING: Do not operate the appliance for more than one minute and 30 seconds continuously. Turn OFF the appliance when placing food in the food chute.

CLEANING AND CARE

WARNING: Ensure the appliance is unplugged from the electrical outlet and the blade has stopped turning before handling or cleaning the appliance.

1. Disassemble all parts & accessories.
2. Wash in hot, soapy water or place in the dishwasher. Wash after each use.

WARNING: The blades are sharp; please handle with care while cleaning. Use the cleaning brush and the cube cleaner to clean the blades to avoid injuries. Do not touch blades with bare hands.

NOTE: Do not place the lid and the motorized base or cord in the dishwasher.

NOTE: When removing food particles using the cube cleaner, ensure Cubing blade A is completely removed from Cubing blade B (P.2 Fig.1). Then, align the cube cleaner on top of Cubing blade A and push the cleaner through the slots using the handle.

3. Dry all the parts & accessories thoroughly and place back in the appliance.
For compact storage, refer to the image below.
4. Wipe the lid and motorized base with a soft, damp cloth and dry thoroughly.

NOTE: Do not place the lid and the motorized base or cord in a dishwasher.

5. Store the cord around the motorized base.

COMPACT STORAGE



TROUBLESHOOTING

Problem	Solution
I cannot close the lid.	Make sure that the blade is well placed inside the mandoline.
The appliance is not working.	Make sure it is plugged in.
	Make sure that the removable protector tray is in the appliance.
	Make sure that the blade is well placed.
	Make sure the lid is well locked and that the power button is firmly pushed.
	Make sure the bowl is well inserted to activate the micro-switch.
I cannot unlock the lid.	Turn the appliance on for one second in order to move the box, then unlock the lid.
The appliance stops while functioning due to a blockage.	Unlock the lid and remove the blade, clean the appliance and its accessories, then turn back on.
The food has stopped coming out of the exit spout	Unlock the lid and remove it. Remove the recipient and the removable protector tray, empty them completely and clean the appliance.