



# Progressive Dynamics, Inc.



Reliable Power  
Conversion Products  
& Accessories



Manufactured and  
Serviced in the USA



*Manufactured and Serviced  
in the USA*

## Why Progressive? What we offer

### Recreational Vehicle Products

Recreational Vehicle power conversion and battery charging products enhanced by our patented Charge Wizard® 4-stage battery management system. This management system constantly monitors voltage status and automatically manages your battery. RV lighting and accessories are also available.

### Specialty Products

Specialty products from Progressive Dynamics, Inc. are suited for various specialty vehicles and other applications for a range of industries.

### Marine Products

A complete range of Marine battery chargers from 20 to 80 Amps. Features a digital display screen, plus a unique patented micro-processor controlled four-stage charging system that offers rapid recharge and two to three times longer battery life.

### Surface Mount Technology / Lithium Battery Charging

Surface mount technology for circuit boards allows for increased reliability and new product features and components. Lithium battery chargers from Progressive Dynamics meet the stringent voltages required for properly charging and maintaining lithium batteries.

### About Progressive Dynamics, Inc.

Progressive Dynamics, Inc. is a privately owned corporation, established in Marshall Michigan in 1964. Its initial product was a high-quality LP gas regulator manufactured for use in recreational vehicle heating and cooking systems.

Today PDI produces a full line of products for the RV, marine and specialty industry. No matter the product, at PDI you receive superior quality and customer service. Our products are designed, assembled, tested, warranted and serviced in the U.S.A.





# Progressive Dynamics, Inc.



## Product Index OEM & Retail

RV	Page
Charge Wizard .....	5
Inteli-Power 4000 Series Converter/Chargers.....	6
Inteli-Power 4135 AC/DC Power Distribution Panel/Converter .....	7
Inteli-Power 4500 Series Converter/Chargers.....	8
Inteli-Power 4600 Series Converter/Chargers.....	9
Inteli-Power 9200 Series Converter/Chargers.....	10-11
Inteli-Power 9100 Series Converter/Chargers.....	12-13
5000 Series AC/DC 120 VAC Power Distribution Panel.....	14
5500 Series AC/DC 240 VAC Power Distribution Panel.....	15
6000 Series DC Power Distribution Panel.....	16
5100 & 5200 Series Automatic Transfer Switches.....	17

SPECIALTY PRODUCTS	
5300 Series Automatic Transfer Switch .....	19
24 Volt Power Converter/Charger Battery Charger.....	19
Inteli-Power 9100L Series Lithium Battery Charger.....	20-21
Inteli-Power Lithium Battery Charger - Wall Mount Series.....	21

MARINE	Page
Inteli-Power 2100 Series Electronic Converter/Chargers.....	22-23

LIGHTING	
750 Series Ceiling Lights .....	24
770 Series Ceiling Lights .....	25
780 Series Ceiling Lights .....	26
790 Series Ceiling Lights .....	27
770 Series 12 Volt LED Ceiling Lights .....	28
790 Series 12 Volt LED Ceiling Lights .....	28
12 Volt Convenience Lights.....	29
12 Volt Reading Lights .....	29
Replacement Lenses for Ceiling Lights.....	30
Lighting Accessories.....	31

*Product specifications are subject to change without notice.*



# Since 1964, Progressive Dynamics, Inc. has been the source of bright ideas for the Recreational Vehicle and Marine Industries

MAKING A DIFFERENCE THROUGH INNOVATION AND DEPENDABILITY

## Progressive Dynamics *Core Values*

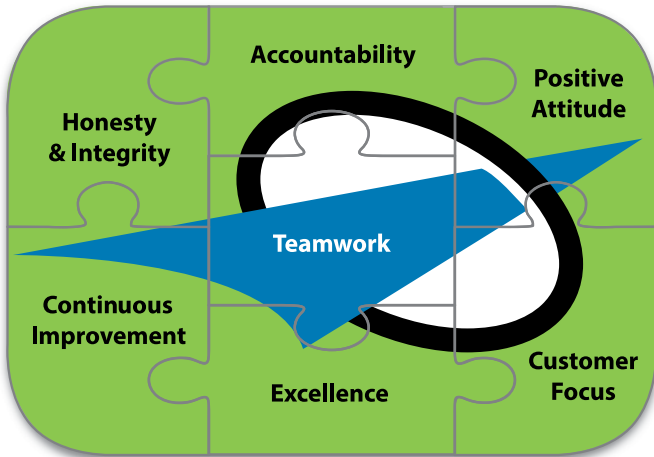

## Warranties and Refunds

1. **LIMITED WARRANTY:** Progressive Dynamics, Inc. warrants its products to be free from defects in material or workmanship under normal use and service; and limits the remedies to repair or replacement.
2. **DURATION:** This warranty is valid only within North America and shall extend from the original date of retail purchase for the period specified below.  
Marine Battery Chargers: 2 Years; RV Power Converters: 2 Years; Low Voltage Lighting: 1 Year; Distribution Panels: 2 Years; Transfer Relays: 1 Year; Reconditioned Products: 1 Year
3. **WARRANTY EXCLUSIONS:** This warranty specifically does not apply to:
  - A. Any product which has been repaired or altered in any way by an unauthorized person or service station;
  - B. Damage caused by excessive input voltage, misuse, negligence or accident; or an external force;
  - C. Any product which has been connected, installed or adjusted or used other than in accordance with the instructions furnished, or has had the serial number altered, defaced or removed;
  - D. Cost of all services performed in removing and reinstalling the product; and
  - E. ANY LOST PROFITS, LOST SAVINGS, LOSS OF USE OF ENJOYMENT OR OTHER INCIDENTAL DAMAGES ARISING OUT OF THE USE OF, OR INABILITY TO USE, THE PRODUCT. THIS INCLUDES DAMAGES TO PROPERTY AND, TO THE EXTENT PERMITTED BY LAW, DAMAGES FOR PERSONAL INJURY.
 THIS WARRANTY IS IN LIEU OF ALL OTHER WARRANTIES, INCLUDING IMPLIED WARRANTIES OF MERCHANTABILITY AND FITNESS FOR A PARTICULAR PURPOSE.
4. **PROOF OF PURCHASE:** A warranty claim must be accompanied by proof of the date of purchase. This may be in the form of a dealer Bill-of-Sale/Invoice, store receipt, or new vehicle title. No prior registration of the converter is necessary to start the standard warranty.
5. **CLAIM PROCEDURE:** Upon discovery of any defect, Progressive Dynamics, Inc. shall be supplied the following information by mail, telephone, fax or email.
  - A. Name and address of the claimant;
  - B. Name and model of the product;
  - C. Date of purchase; and
  - D. Complete description of the claimed defect.
  - E. Recreational Vehicles: Name, year, and model of vehicle in which product was installed.
  - F. Marine Craft: Name, year, and model of craft in which product was installed.

Upon determination that a warranty claim exists (a defect in material or workmanship occurring under normal use and service,) the product shall be shipped postage prepaid to Progressive Dynamics, Inc. together with proof of purchase. The product will be repaired or replaced and returned postage prepaid.



Manufactured and Serviced in the USA



## CHARGE WIZARD®

### Tired of Replacing Batteries?

#### DON'T LET THIS HAPPEN TO YOUR CUSTOMERS!

Customer complaints are “history” when installing a Progressive Dynamics converter with the patented automatic 4-stage Charge Wizard® system. The Charge Wizard has been shown to increase battery life by 2 to 3 times or more.

Our patented Charge Wizard 4-stage system uses microprocessor technology to add intelligent charging capability. It constantly monitors the RV battery and automatically adjusts the converter output voltage based on the battery's charge status – designed to eliminate battery over & under charging problems associated with most other battery chargers and provide rapid yet safe battery recharging after dry camping.

The Charge Wizard constantly monitors battery voltage and battery usage then selects one of the following four operating modes to properly charge and maintain the battery.

**BOOST Mode** 14.4 Volts – Rapidly brings the RV battery up to 90% of full charge.

**NORMAL Mode** 13.6 Volts – Safely completes the charge.

**STORAGE Mode** 13.2 Volts – Maintains charge with minimal gassing or water loss.

**EQUALIZATION Mode** 14.4 Volts – Every 21 hours for a period of 15 minutes prevents battery stratification & sulfation — the leading cause of battery failure.

The Charge Wizard technology is built into all our PD4000, PD4500, PD4600 and PD9200 series converters/chargers. The Charge Wizard is also available as a pendant (as shown on the right). This allows easy field upgrade to your PD9100 series deck mount converter/charger by simply plugging the pendant into the built-in TCMS® connector located just above the fuses on the output panel.



#### Retail Models:

PD9105V for charging flooded lead-acid and AGM batteries

#### OEM Models:

PD9105 for charging flooded lead-acid and AGM batteries

#### Retail Display Package

*Colorful graphics grab attention and the large window shows the product. The package is designed for pegboard or slatwall display.*



# RV Converter/Chargers with built-in Charge Wizard®

## INTELI-POWER® 4000 SERIES

"MIGHTY MINI" THE COMPACT ALL-IN-ONE SYSTEM...  
AC/DC DISTRIBUTION PANEL AND INTELI-POWER CONVERTER.

### Features:

Industry's smallest all-in-one 45 or 60 Amp distribution panel/converter system. Available with our exclusive built-in Intelli-Power Converter...

**"The most reliable converter in the RV industry."**

The converter section is easily accessible from the front.

AC Distribution Panel is rated for 120 VAC @ 30 Amps with up to 7 branch circuits.

The DC section has 12 branch fuse holders, two wired to accommodate 30 Amp fuses, ten more with a maximum rating up to 20 Amps each. All wire tail connections.

Exclusive DC disconnect tie in.

Reverse battery blown fuse indicator.

Retail Models:

PD4045KV & PD4060KV

### Other Features:

- Compact & lightweight
- Reverse battery protection with easy to replace fuses
- Electronic current limiting
- High and low AC input protection
- Intelligent, variable speed, cooling fan
- Automatic thermal protection
- Front access to large wiring compartment
- Snap-lock cover stays shut while traveling – opens with a touch
- Attractive lightweight panel design made from black impact-resistant high temperature polymers.

### Specifications:

**Panel Dimensions:** 12.28"W x 8.875"H x 7.25"D

**Cutout Size:** 10.75"W x 7.25"H

**Weight:** 45 Amp Model, 5.6 lbs.; 60 Amp Model, 6.2 lbs.

**Replacement Converter Section:**

Model PD4045CSV, Weight: 3.0 lbs.

Model PD4060CSV, Weight: 4.0 lbs.

**PD4045KA Converter**

Input: 105-130VAC 50/60HZ 725 Watts

Output: 13.6VDC 45 Amps

**PD4060K Converter**

Input: 105-130VAC 50/60HZ 1,025 Watts

Output: 13.6VDC 60 Amps



Built-in Charge Wizard constantly monitors voltage status and automatically manages your battery. Intelli-Power 4000 Mighty Mini models can recharge the battery to 90% in 3-6 hours using our patented Charge Wizard technology.



PD4060K

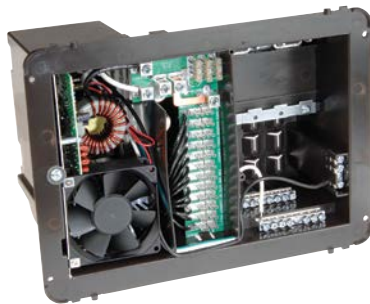

PD4045KA



PD4060



Manufactured and Serviced  
in the USA



Covered by one or more of the following U.S. Patents: 7,782,002 and RE39,461.

# AC/DC Distribution Panel/Converter with built-in Charge Wizard®

**INTELI-POWER® 4135** COMPACT ALL-IN-ONE-SYSTEM...  
DIRECT REPLACEMENT FOR WFCO 8735!

### Features:

Available with our exclusive built-in Intelli-Power Converter...

*"The most reliable converter in the RV industry."*

The converter section is easily servicable. The AC Distribution Panel is rated for 120 VAC @ 30 Amps with up to 5 branch circuits.

The DC section has 6 branch fuse holders. Retail model includes all wire tails for ease of installation. OEM models have 1/4" tab connectors.

LED indicators identify which fuse is blown.

Easy access to reverse battery protection fuse.

Replaceable converter section.

### Specifications:

**Panel Dimensions:** 11.25"W x 8"H x 3.8"D

**Cutout Size:** 10.25"W x 7.0"H

**Weight:** 3.8 lbs.

**Retail model PD4135KV**

Input: 105-130VAC 50/60HZ 550 Watts

Output: 13.6VDC 35 Amps

DC rating 1-40A, 1-30A, 4-20A fuse holders

**OEM model PD4135K**

Input: 105-130VAC 50/60HZ 550 Watts

Output: 13.6VDC 35 Amps

DC rating 1-40A, 5-30A fuse holders

ETL approval pending



Built-in Charge Wizard constantly monitors voltage status and automatically manages your battery. The Intelli-Power 4135 can recharge the battery to 90% in 3-6 hours using our patented Charge Wizard technology.



Manufactured and Serviced in the USA



Covered by one or more of the following U.S. Patents: RE39,461 and 7,782,002.

# RV Converter/Chargers with built-in Charge Wizard®

## INTELI-POWER® 4500 SERIES

THE ULTIMATE ALL-IN-ONE 240V INPUT VOLTAGE,  
50 AMP AC/DC DISTRIBUTION PANEL

### Inteli-Power AC Features:

The AC Distribution Panel is rated for 240V input voltage at 50 Amps.

Provisions for up to 12 branch circuit breakers plus a center feed dual 50 Amp main breaker (not included).

12 built-in push and lock strain relief wiring connectors make installation quick and easy and saves over 50% on installation costs.

Attractive lightweight panel design made from black impact-resistant high temperature polymers.

### Inteli-Power DC Features\*:

Top two fuse holders recommended for low current devices such as smoke and carbon monoxide detectors.

Optional 12 branch fuse holders with 2-30 Amp circuits or 18 branch fuse holders with 4-30 Amp circuits. Maximum rating 20 Amps on remaining circuits — available with optional wire tail connections.

Optional L.E.D. indicators identify which fuse is blown.

Converter/Charger section is accessible from the front.

Converter/Charger ratings of 60, 75 and 90 Amps which is the largest rating available in the industry.

Easy access reverse battery protection fuses.

Optional DC disconnect tie in.

*\*Customer must supply options when ordering.*



Built-in Charge Wizard constantly monitors voltage status and automatically manages your battery. Inteli-Power 4500 Series models can recharge the battery to 90% in 3-6 hours using our patented Charge Wizard technology.

### Other Features:

- Reverse battery protection
- Electronic current limiting
- High and Low AC input protection
- Intelligent, variable speed, cooling fan
- Automatic thermal protection
- Press open door for easy access to circuit breakers
- Front access to large wiring compartment
- Optional DC Ground Bus can be user installed in the DC wiring compartment.

### Specifications:

**Panel Dimensions:** 11.85"W x 14.125"H x 7.80"D

**Cutout Size:** 10.125"W x 13.25"H

**Weight:** 60 Amp Model, 8 lbs., 75 Amp Model, 8.5 lbs., 90 Amp Model, 10 lbs.

#### Replacement Converter Section:

Model PD4560CSV, Weight: 5.25 lbs.

Model PD4575CSV, Weight: 5.5 lbs.

Model PD4590CSV, Weight: 6.1 lbs.

#### PD4560 Converter

Input: 105-130VAC 50/60HZ 1025 Watts

Output: 13.6VDC 60 Amps

#### PD4575 Converter

Input: 105-130VAC 50/60HZ 1300 Watts

Output: 13.6VDC 75 Amps

#### PD4590 Converter

Input: 105-130VAC 50/60HZ 1550 Watts

Output: 13.6VDC 90 Amps



PD4560 / PD4575



PD4590



Now Available  
in 75 Amp!



Manufactured and Serviced  
in the USA



Covered by one or more of the following U.S. Patents: 6,424,520; RE39,461 and 7,782,002.



# RV Converter/Chargers with built-in Charge Wizard®

## INTELI-POWER® 4600 SERIES

UPGRADE OR REPLACEMENT FOR MANY  
RV POWER CENTER CONVERTER/CHARGERS

### Features:

Charge Wizard 4-Stage charging system built-in dramatically increases battery life.

This converter/charger will not boil the battery!

55 Amp (PD4655V), 45 Amp (PD4645V) and 35 Amp (PD4635V) models available.

The intelligent way to charge & maintain your RV battery.

Easy to install.

### Specifications:

**Dimensions:** 13.25"W x 8"D x 5.38"H

**Weight:** 35 & 45 Amp Models, 9 lbs. ; 55 Amp Model, 10 lbs.

**Inteli-Power 55 Amp Converter/Charger**

**Model #PD4655V replaces these converter sections:**

Parallax/Magnatek #6355, Parallax #7355, Parallax #8355, Parallax #7155, WFCO™ #8955

**Inteli-Power 45 Amp Converter/Charger**

**Model #PD4645V replaces these converter sections:**

Parallax/Magnatek #6345, Parallax #7345, Parallax #8345, WFCO™ #8945

**Inteli-Power 35 Amp Converter/Charger**

**Model #PD4635V replaces these converter sections:**

Parallax/Magnatek #6336, WFCO™ #8935

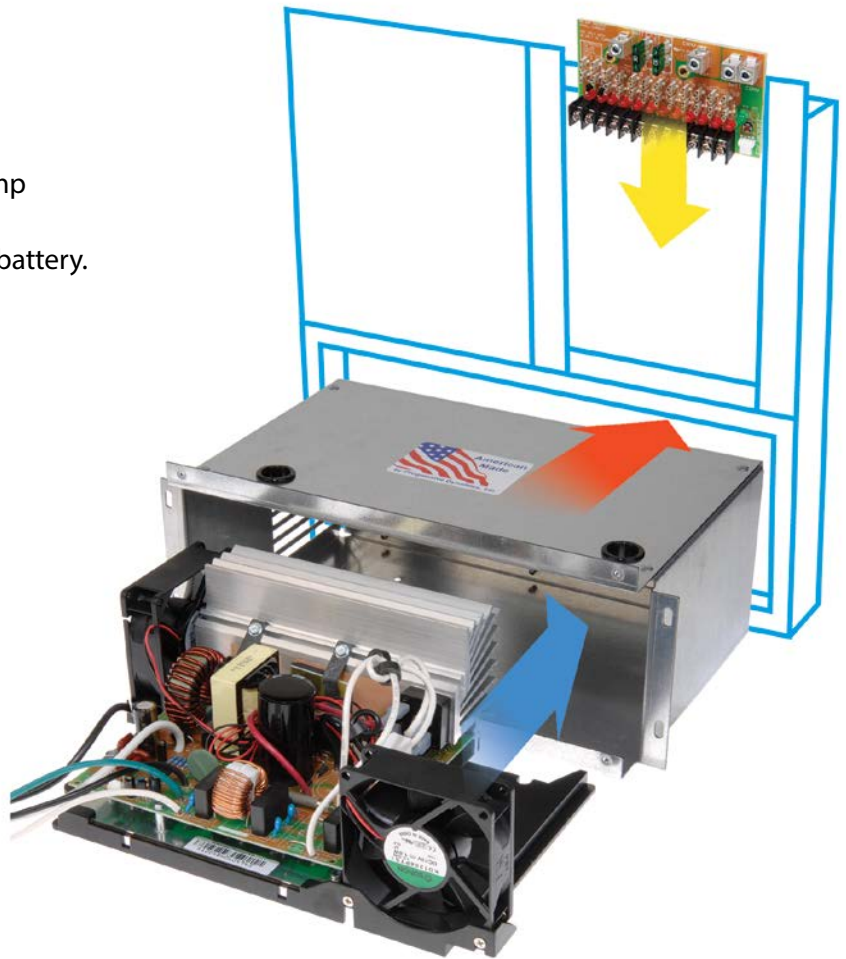

Built-in Charge Wizard constantly monitors voltage status and automatically manages your battery. Inteli-Power 4600 Series models can recharge the battery to 90% in 3-6 hours using our patented Charge Wizard technology.



### Retail Display Package

Colorful graphics grab attention. Product features and benefits present a strong sales message.



A metal enclosure is included in every package for replacement Parallax/Magnatek 6300 Series, 7300 Series or 8300 Series Converter.



Manufactured and Serviced  
in the USA



Covered by the following U.S.  
Patent: 7,782,002.

# 12 Volt RV Converter/Chargers with built-in Charge Wizard®

## INTELI-POWER® 9200 SERIES

ALL MODELS AVAILABLE FOR LEAD-ACID OR AGM BATTERIES, ENGINEERED FOR POWER-HUNGRY APPLICATIONS



Built-in Charge Wizard constantly monitors voltage status and automatically manages your battery. Intelli-Power 9200 Series models can recharge the battery to 90% in 3-6 hours using our patented Charge Wizard technology.

The built-in Charge Wizard automatically selects one of four operating modes: **BOOST, NORMAL, STORAGE, EQUALIZATION.**

**BOOST Mode:** 14.4 Volts – Rapidly brings RV battery up to 90% of full charge.

**NORMAL Mode:** 13.6 Volts – Safely completes the charge.

**STORAGE Mode:** 13.2 Volts – Maintains charge with minimal gassing or water loss.

**EQUALIZATION Mode:** 14.4 Volts – Every 21 hours for a period of 15 minutes to prevent battery stratification & sulfation.



### Retail Model Pendant PD92201

Plugs into the accessory port to show charger/converter status and allows for manual mode selection. The pendant is included with all retail models.

U.S. Patent 6,184,649



Charge Wizard pendant plugs into the accessory port located on the right side.



### Retail Display Package

Colorful graphics grab attention. Product features and benefits are displayed on all panels.



Manufactured and Serviced in the USA



Covered by the following U.S. Patent: 7,782,002.

**Standard features on all models:**

- Equipped with 15 amp electrical cord. (with the exception of the 80 amp models)
- Built-in Charge Wizard constantly monitors voltage status and automatically manages your battery.
- Built-in accessory port for optional, Pendant (standard on retail units) to monitor Charge Wizard operating modes.
- Reverse battery protection protects converter from damage resulting from improper (reverse) battery lead connection.
- These solid-state converter/chargers deliver filtered DC power to all 12 Volt lighting and appliance circuits providing safe and reliable service.
- Electronic current limiting automatically reduces output voltage when maximum capacity is reached. Protects your investment and offers peace of mind.
- Low line voltage protection automatically shuts converter down if input voltage is insufficient and protects your appliances from damaging low voltage irregularities.
- Variable speed intelligent cooling fan automatically monitors converter temperature and activates fan at speed required. Very slow quiet speeds are used when demand is low such as during sleeping hours.
- High voltage protection protects converter from spikes or surge of voltage over 135V.
- Automatic thermal protection reduces converter output to safe levels when unit temperature exceeds pre-set limits and protects converter from damage due to excessive heat.
- 2 year limited warranty.

**Retail Model PD9280V\***  
**OEM Model PD9280\***  
 Input: 105-130 VAC, 50/60 Hz, 1300 Watts  
 Output: 13.6 VDC, 80 Amp  
 Dimensions: 11.65"L x 7.38"W x 3.6"H  
 Weight: 7.5 lbs.

**80  
AMP**



**Retail Model PD9270V**  
**OEM Model PD9270**  
 Input: 105-130 VAC, 50/60 Hz, 1250 Watts  
 Output: 13.6 VDC, 70 Amp  
 Dimensions: 9.15"L x 7.38"W x 3.6"H  
 Weight: 5.8 lbs.

**70  
AMP**



 \*Plugs into a 20 amp outlet. Removal or alteration of converter 20 Amp power cord will void warranty.

**Retail Model PD9260CV**  
**OEM Model PD9260C**  
 Input: 105-130 VAC, 50/60 Hz, 1000 Watts  
 Output: 13.6 VDC, 60 Amp  
 Dimensions: 9.15"L x 7.38"W x 3.6"H  
 Weight: 5.8 lbs.

**60  
AMP**



**Retail Model PD9245CV**  
**OEM Model PD9245C**  
 Input: 105-130 VAC, 50/60 Hz, 725 Watts  
 Output: 13.6 VDC, 45 Amp  
 Dimensions: 8.25"L x 7.25"W x 4.7"H  
 Weight: 4.5 lbs.

**45  
AMP**



# Electronic RV 12 Volt Converter/Chargers

## INTELI-POWER® 9100 SERIES

THE 12 VOLT CONVERTER/CHARGERS OF CHOICE  
BY LEADING MANUFACTURERS



## Engineered for Power-Hungry Applications

30, 40, 45, 60, 70 & 80 Amp Models Available



TCMS Charge Wizard plugs into the accessory port located on the output panel.

### Standard features on all models:

- Equipped with 15 Amp electrical cord.
- Reverse battery protection protects converters from damage resulting from improper (reverse) battery lead connection.
- These solid-state converter/chargers deliver filtered DC power to all 12 Volt lighting and appliance circuits providing safe and reliable service.
- Electronic current limiting automatically reduces output voltage when maximum capacity is reached. Protects your investment.
- Low line voltage protection automatically shuts converter down if input voltage is insufficient and protects appliances from damaging low voltage irregularities.
- Variable speed intelligent cooling fan automatically monitors converter temperature and activates fan at speed required. Very slow quiet speeds are used when demand is low such as during sleeping hours.
- High voltage protection protects converter from spikes or surge of voltage over 135V.
- Automatic thermal protection reduces converter output to safe levels when unit temperature exceeds pre-set limits and protects converter from damage due to excessive heat.
- Built-in Total Charge Management System® (TCMS) connector accepts the optional Charge Wizard that constantly monitors voltage status and automatically manages your battery. (see pages 13 & 5)
- 2 year limited warranty.

### Retail Display Package

Colorful label on sturdy carton displays converter design and Amp rating.



Manufactured and Serviced  
in the USA



Covered by the following U.S.  
Patent: 7,782,002.

**Retail Model PD9180V\***  
**OEM Model PD9180\***  
 Input: 105-130 VAC,  
 50/60 Hz, 1300 Watts  
 Output: 13.6 VDC, 80 Amp  
 Dimensions:  
 11.65"L x 7.38"W x 3.6"H  
 Weight: 7.5 lbs.



\* Plugs into a 20 amp outlet. Removal or alteration of converter 20 Amp power cord will void warranty.

**80  
AMP**



**Retail Model PD9170AV**  
**OEM Model PD9170A**  
 Input: 105-130 VAC,  
 50/60 Hz, 1250 Watts  
 Output: 13.6 VDC, 70 Amp  
 Dimensions:  
 9.15"L x 7.38"W x 3.6"H  
 Weight: 5.8 lbs.

**70  
AMP**



**Retail Model PD9160AV**  
**OEM Model PD9160A**  
 Input: 105-130 VAC,  
 50/60 Hz, 1000 Watts  
 Output: 13.6 VDC, 60 Amp  
 Dimensions:  
 9.15"L x 7.38"W x 3.6"H  
 Weight: 5.8 lbs.

**60  
AMP**



**Retail Model PD9145AV**  
**OEM Model PD9145A**  
 Input: 105-130 VAC,  
 50/60 Hz, 725 Watts  
 Output: 13.6 VDC, 45 Amp  
 Dimensions:  
 8.25"L x 7.25"W x 4.5"H  
 Weight: 4.5 lbs.

**45  
AMP**



**Retail Model PD9140AV**  
**OEM Model PD9140A**  
 Input: 105-130 VAC,  
 50/60 Hz, 600 Watts  
 Output: 13.6 VDC, 40 Amp  
 Dimensions:  
 8.25"L x 7.25"W x 4.7"H  
 Weight: 4.5 lbs.

**40  
AMP**



**Retail Model PD9130V**  
**OEM Model PD9130**  
 Input: 105-130 VAC,  
 50/60 Hz, 500 Watts  
 Output: 13.6 VDC, 30 Amp  
 Dimensions:  
 8.25"L x 7.25"W x 4.7"H  
 Weight: 4 lbs.

**30  
AMP**



### Plug in a Charge Wizard

Provides rapid battery recharge for dry campers. The intelligent way to automatically charge batteries! TCMS® (Total Charge Management System) allows for the addition of a Progressive Dynamics Charge Wizard, a powerful microprocessor that turns your Intelli-Power Converter into an intelligent, completely automatic 12 Volt charging system. It constantly monitors battery voltage and then selects one of four operating modes to properly maintain and recharge the battery.



*A powerful microprocessor that "automates" everything!*

# AC/DC Power Distribution Panels

## 30 AMP, 120 VAC 5000 SERIES

ATTRACTIVE, COMPETITIVELY PRICED CONTROL CENTER THAT FITS YOUR ELECTRICAL INSTALLATION COST REQUIREMENTS

### Features:

Provisions for 30 Amp AC main and up to 9 AC branch circuits.

Generous wiring space for easy installation — also reduces costly wiring errors.

Built-in wire strain relief for each branch circuit. Saves over 50% on installation costs.

Space for up to 12 fused DC branch circuits for 12 Volt lighting and DC appliance circuits.

Accepts rated fuses up to 30 Amp — eliminates auxiliary fuse panels for slide-outs and leveling jacks saving you even more money.

Attractive lightweight panel design made from black or brown impact-resistant high temperature polymers.

All 12 VDC branch circuit connections located on outside rear of panel — reducing installation time and costly errors.

High current 12 VDC input power terminal strip provides easy connection point for battery and converter.

### Available Options:

(Specify options when ordering)

- 120 VAC, 15 Amp outlet available for power converters and other AC appliances.
- 11 terminal negative 12 VDC bus bar provides common connection point for all DC circuit negative wires.

### Connector type and product color must be specified:

- 12 VDC screw-type circuit terminals.
- 12 VDC 1/4" tab connectors.
- Available in black or brown.

### Measurements and Weight\*:

Dimensions: 13.4"W x 7.1"H x 4.0"D

Cut-out size: 12.25"W x 5.875"H

Weight: 1.45 lbs.

\*Retail and OEM Part Numbers will be determined by your selected options when you place your order.



Inside with full front cover off



Rear view showing screw connections

Front control panel – access cover removed



Manufactured and Serviced  
in the USA



Covered by one or more of the following U.S. Patents: RE39,461; 6,424,520; RE40,354; 6,430,036.

# AC/DC Power Distribution Panels

## 50 AMP, 240 VAC 5500 SERIES

VERSATILE! CAN BE TWO PANELS IN ONE  
TO SAVE COST AND SPACE

### Features:

A split 50/30 panel accepts — LEFT SIDE: dual 50 Amp main and up to 10 branch circuits — RIGHT SIDE: 30 Amp main and up to 4 branch circuits.

A split 50/50 panel accepts — LEFT SIDE: dual 50 Amp main and up to 8 branch circuits — RIGHT SIDE: dual 50 Amp main and up to 4 branch circuits.

A split 30/30 panel accepts — LEFT SIDE: 30 Amp main and up to 8 branch circuits — RIGHT SIDE: 30 Amp main and up to 8 branch circuits.

Special order configurations available on request.

Compatible with 6000 Series DC Power Distribution Panel.

Press open door for easy access to circuit breakers.

AC Panel features 12 built-in push and lock strain relief connectors.

Attractive lightweight panel design made from black or brown impact-resistant high temperature polymers.

AC Panel designed with large front wiring compartment.

### Available Options:

(Specify options when ordering)

- Optional 15 Amp/120 VAC outlet on rear of AC Panel

### Measurements and Weight\*:

Dimensions: 11.7"W x 9.2"H x 4.1"D

Cut-out size: 10.5"W x 7.5"H

Weight: 2 lbs.

\*Retail and OEM Part Numbers will be determined by your selected options when you place your order.



Manufactured and Serviced  
in the USA



Covered by one or more of the  
following U.S. Patents: RE39,461  
and 6,424,520.



Press open circuit breaker access door



Mount vertical  
or horizontal



12 Built-in strain-relief  
wiring connectors



# 12 Volt DC Power Distribution Panels

## 6000 SERIES

DC POWER DISTRIBUTION PANEL COMPATIBLE WITH  
5500 SERIES AC POWER DISTRIBUTION PANEL

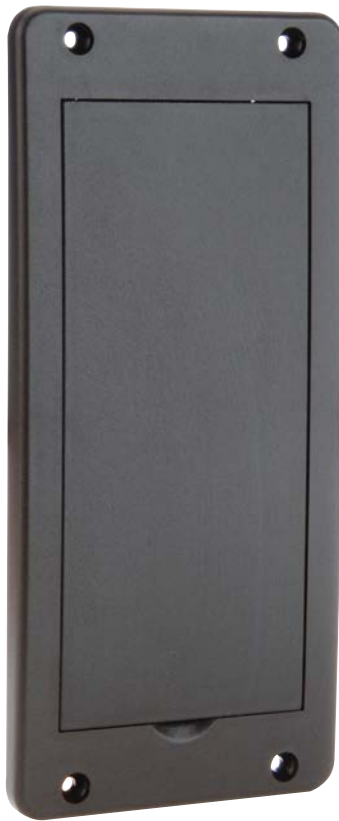

Cover open

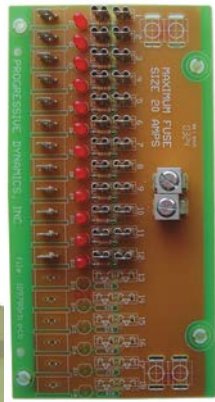

*SURFACE MOUNT MODEL  
available with all 6000 Series options except  
ground bar and color options*

*Not approved for Canada*

### Features:

Can be mounted vertically or horizontally.

Holds up to 18 ATC-type fuses rated for up to 30 Amps.

DC Panel has 2 built-in 12 Volt positive power terminals for connecting battery and converter positive wires.

Attractive light weight panel design made from black or brown impact-resistant high temperature polymers.

### Available Options:

(Specify options when ordering)

- 12 Volt DC output connectors available as either 1/4" tab connectors rated 30 Amps max. or screw-type rated 20 Amps max.
- Available in 12 fuse holders with 11-position ground bus bar.
- 18 fuse holder with 15-position ground bus bar.
- LED indicators alert to blown fuse.

### Measurements and Weight\*:

(Flush mount)

Dimensions: 4.25"W x 9.25"H x 2.0"D

Cut-out size: 3.5"W x 7.5"H

Weight: 1lb.

### Measurements and Weight:

(Surface mount)

Dimensions: 6.85"W x 3.65"H

Weight: 1 lb.

\*Retail and OEM Part Numbers will be determined by your selected options when you place your order.



Optional 1/4" tab  
connectors





# Automatic Transfer Switches

## 5100 / 5200 SERIES

SCREW TYPE WIRING TERMINALS ENSURE  
EASE OF WIRING AND PREVENTS WIRING ERRORS

### 5100 Series Automatic Transfer Switch

#### Features:

Quick change circuit board is easily replaced in the event of failure. No need to disconnect and reinstall the entire unit.

Time delay feature ensures generator voltage is at a stable level before transfer occurs.

Built-in strain reliefs allow the installer to simply push the branch circuit wires inside the unit for connection.

Eliminates the need to purchase and install separate strain reliefs for each circuit.

Screw-type wiring terminals ensure ease of wiring and prevents wiring errors.

1 year limited warranty.

U.S. Patents: RE40,354; 6,430,036.

**Retail Model PD5110010V**

**OEM Model PD5110010**

120 VAC, 30-Amps

Pig tail AC wire connections

Dimensions: 9.25"L x 7.28"W x 4.2"H

Weight: 2.5 lbs.

**Retail Model PD5110610V**

**OEM Model PD5110610**

120 VAC, 30-Amps

AC Connectors: Screw terminals

Dimensions: 9.25"L x 7.28"W x 4.2"H

Weight: 2.5 lbs.

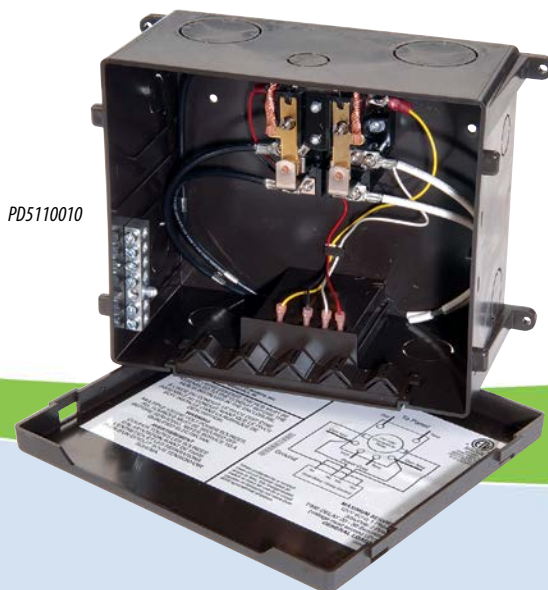

PD5110010

### 5200 Series Automatic Transfer Switch

#### Features:

Rugged, heavy duty, screw type wiring terminals ready to wire to contactor base. Ensure ease of wiring and prevents wiring errors.

Time delay circuit board ensures generator voltage is at a stable level before transfer occurs.

Easy to remove protective cover with wiring schematic inside.

AC Detect option for auto generator start compatibility.

70 Amp neutral rating.

1 year limited warranty.

**Retail Model PD52V**

**OEM Model PD52**

240 VAC, 50 Amps

Metal Box Dimensions: 10.38"L x 6.88"W x 4.5"H

Weight: 7 lbs.

**NEW! Retail Model PD52DCSV**

**NEW! OEM Model PD52DCS**

**Silent Surge Protection** – see [www.progressivedyn.com](http://www.progressivedyn.com) for product specifications

Surge protected, 240 VAC, 50 Amps

Metal Box Dimension: 10.25"L x 8.25"W x 5.5"H

Weight: 9.8 lbs.

**NEW! PD52S**

See [www.progressivedyn.com](http://www.progressivedyn.com) for product specifications

Surge protected, 240 VAC, 50 Amps

Metal Box Dimension:

10.25"L x 8.25"W x 5.5"H

Weight: 8.5 lbs.



PD52V

PD52DCSV



Manufactured and Serviced  
in the USA



# SPECIALTY PRODUCTS

SPECIALTY PRODUCTS FROM PROGRESSIVE DYNAMICS, INC. ARE SUITED FOR VARIOUS SPECIALTY VEHICLES AND OTHER APPLICATIONS FOR A RANGE OF INDUSTRIES.



# Specialty Vehicle & Other Applications

## 5300 SERIES

CONTACTOR DESIGNED  
AUTOMATIC TRANSFER SWITCH

Provides automatic power source switching between two separate 120/240 VAC input sources. A typical application is to switch between a shoreline connected cord and an onboard generator. The transfer switch senses the presence of the available supplies and automatically selects the proper one.

### Standard features:

- Electrical and mechanical interlocks prevent cross connection of power sources.
- Quick change circuit board is easily replaced in the event of failure. No need to disconnect and reinstall the entire unit.
- Time delay ensures generator voltage is at a stable level before transfer occurs. The time delay can be disabled when an inverter is used as the alternate source.
- Rugged, heavy-duty, screw-type wiring terminals allow direct connection to contactor for more reliable operation.
- Heavy Duty metal enclosure with easy to use wiring diagram permanently attached.
- 1 year limited warranty.



### Specifications\*:

**PD53-100**  
Voltage: 120/240 VAC  
Amperage: 100 Amps  
Dimensions: 12"L x 10"W x 6"H  
Weight: 17 lbs.

\*Not agency listed.



Manufactured and Serviced  
in the USA

## 24 VOLT

25 & 40 AMP POWER CONVERTER/  
BATTERY CHARGER

### Inteli-Power 9200® Series Power Converter/Battery Charger for Specialty Vehicles and Other Applications with Built-in, Patented 4-Stage Charging for Better Battery Management

Provides 24 volt output in either a 25 amp or 40 amp configuration. Typical applications include battery charging for shuttle buses, local refrigeration delivery trucks, display vans, emergency vehicles, communication trucks, over-the-road trucks with sleeper cabs, and solar energy.

### Standard features:

- Built-in Charge Wizard®, 4-stage charging system constantly monitors batteries and automatically adjusts your converter output voltage based on the battery's charge status.
- Made in America for better quality, service and support.
- Reverse battery protection protects converter from damage resulting from improper (reverse) battery lead connection.
- Electronic current limiting automatically reduces output voltage when maximum capacity is reached.
- 2 year limited warranty.



### Specifications\*\*:

**PD9240-24\***  
Input: 105-130 VAC, 50/60 Hz,  
1300 Watts  
Output: 27.2 VDC, 40 Amp  
Dimensions:  
11.65"L x 7.38"W x 3.6"H  
Weight: 7.5 lbs

**PD9225-24**  
Input: 105-130 VAC, 50/60 Hz,  
900 Watts  
Output: 27.2 VDC, 25 Amp  
Dimensions:  
8.25"L x 7.25"W x 4.7"H  
Weight: 4.5 lbs.



\*Plugs into a 20 amp outlet. Removal or alteration of converter 20 Amp power cord will void warranty.

\*\*Not agency listed.



Covered by the following U.S.  
Patent: 7,782,002.

# 12 & 24 Volt Lithium Ion Battery Converter/Chargers

## INTELI-POWER® 9100L SERIES

DESIGNED TO MEET STRINGENT VOLTAGES REQUIRED FOR PROPERLY CHARGING & MAINTAINING LITHIUM ION BATTERIES

## Engineered for Power-Hungry Applications

25, 30, 45, 60 & 80 Amp Models Available

### Standard features on all models:

- Reverse battery protection protects converters from damage resulting from improper (reverse) battery lead connection.
- Units deliver filtered DC power to the Lithium Ion Batteries to ensure their built-in electronic balancing circuits operate properly.
- Electronic current limiting automatically reduces output voltage when maximum capacity is exceeded. Protects your investment.
- Low line voltage protection automatically shuts converter down if input voltage is insufficient.
- Variable speed intelligent cooling fan automatically monitors converter temperature and activates fan at speed required.
- High voltage protection protects converter from spikes or surge of voltage over 135V.
- Automatic thermal protection reduces converter output to safe levels when unit temperature exceeds pre-set limits and protects converter from damage due to excessive heat.
- Output Voltage can be FACTORY ADJUSTED to meet OEM requirements for various Lithium Ion Battery Chemistries and Voltages. Standard "L" Series Voltages are set for 14.6/28.55 Volts to meet requirements for Lithium Iron Phosphate batteries. Other chemistries may require different voltages.
- The PD9100L Series can be wired in parallel to charge at much higher current rates. They can also be wired in Series/Parallel to charge 36, 48, 60, 72 and higher Voltage Battery packs at high charge rates.
- 2 year limited warranty.

### What are the advantages of lithium ion batteries?

Stores 3-4 times the energy of a lead/acid battery in the same space, with less weight.

Nearly constant output voltage during discharge. Delivers full power longer to all systems improving performance.

Operates over a wide range of temperatures. -4F to +158F.

Can charge and discharge thousands of times vs. 300-400 cycles for lead/acid batteries.

Retains 80% of charge for 12 months, vs. lead/acid batteries, which discharge to 80% of capacity in only 30 days!

Lithium ion batteries do not require maintenance. No more adding water. No more venting of explosive gasses!

Lithium ion batteries are the future, providing excellent performance in golf carts, electric vehicles, solar power storage, ups power back-up systems, forklifts and many other applications.

### Lithium Ion Batteries Require Special Balancing Circuits and Chargers!

12-Volt Lithium Ion batteries are composed of 4 Cells, each with a Voltage rating of 3.2-Volts wired in series providing a total output of 12.8 Volts. Lithium Iron Phosphate type Cells, are the safest and most common type used however, they must never be charged to a voltage over 4-Volts and must never be discharged below 2-Volts, or they will be damaged. Note: other Cell chemistries require different voltage limits.

Due to manufacturing inconsistencies each Lithium Ion Cell is different (i.e. they will each charge and discharge at different rates). These Cell differences make recharging Lithium batteries fairly complex and requires that the battery manufacture install Electronic Balancing Circuits inside the battery to prevent overcharging a Cell, or discharging too much. While these Balancing Circuits protect the Cells, they can increase recharge times, depending on the mix of Cells in each 12-Volt battery pack. This increase in recharge time is especially apparent in higher voltage and or higher Current battery packs. Lithium Ion batteries also require battery chargers that can produce a higher voltage than provided by standard 12-Volt or 24-Volt Lead/Acid Battery Chargers. Trying to recharge a Lithium Ion Battery with a standard Lead/Acid Charger will result in a partially charged battery and may REDUCE BATTERY Life!



Manufactured and Serviced  
in the USA



Covered by U.S. Patent: 7,782,002.

**MODEL PD9180LV**

Input: 105-130 VAC 50/60 Hz.  
1300 Watts  
Output: 14.6 Volts VDC 80-Amps  
Dimensions: 11.65"L x 7.38"W x 3.6"H  
Weight: 7.5 lbs.

**80  
AMP**



**Model PD9160ALV**

Input: 105-130 VAC 50/60 Hz.  
1025 Watts  
Output: 14.6 Volts VDC 60-Amps  
Dimensions: 9.15"L x 7.38"W x 3.6"H  
Weight: 5.8 lbs.

**60  
AMP**



**Model PD9145ALV**

Input: 105-130 VAC 50/60 Hz.  
725 Watts  
Output: 14.6 Volts VDC 45-Amps  
Dimensions: 8.25"L x 7.25"W x 4.7"H  
Weight: 4.5 lbs.

**45  
AMP**



**Model PD9130LV**

Input: 105-130 VAC 50/60 Hz.  
500 Watts  
Output: 14.6 Volts VDC 40-Amps  
Dimensions: 8.25"L x 7.25"W x 4.7"H  
Weight: 4 lbs.

**30  
AMP**



**Model PD9140-24LV\***

Input: 105-130 VAC 50/60 Hz.  
1,375 Watts  
Output: 28.55 Volts VDC 40-Amps  
Dimensions: 11.65"L x 7.38"W x 3.6"H  
Weight: 7.5 lbs.

**40  
AMP**



**Model PD9125-24LV**

Input: 105-130 VAC 50/60 Hz.  
900 Watts  
Output: 28.55 Volts VDC 25-Amps  
Dimensions: 8.25"L x 7.25"W x 4.7"H  
Weight: 4.5 lbs.

**25  
AMP**



Plugs into a 20 amp outlet. Removal or alteration of converter 20 amp power cord will void warranty.  
\*This model is not UL Listed.

## All-In-One Lithium Ion Battery Converter/Chargers

### INTELI-POWER® WALL MOUNT SERIES

FAST CHARGING TIMES — UP TO 99% IN 2.5 HOURS  
VERSUS UP TO 13 HOURS FOR LEAD ACID BATTERIES

**Model PD4560LIK18LS8**

Input: 105-130 VAC 50/60 Hz.  
1025 Watts  
Output: 14.6VDC 60-Amps  
Dimensions:  
11.85"W x 14.125"H x 7.80"D  
Cutout Size: 10.125"W x 13.25"H  
Weight: 8 lbs.

**60  
AMP**



**Model PD4045LIK**

Input: 105-130 VAC 50/60 Hz.  
1025 Watts  
Output: 14.6VDC 60-Amps  
Dimensions:  
11.85"W x 14.125"H x 7.80"D  
Cutout Size: 10.125"W x 13.25"H  
Weight: 8 lbs.

**45  
AMP**



**Model PD4060LIK**

Input: 105-130 VAC 50/60 Hz.  
1025 Watts  
Output: 14.6VDC 60-Amps  
Dimensions: 12.28"W x 8.875"H x 7.25"D  
Cutout Size: 10.75"W x 7.25"H  
Weight: 6.7 lbs.

**60  
AMP**

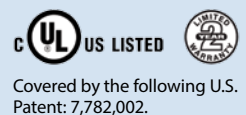

# Marine Electronic Converter/Chargers

## INTELI-POWER® 2100 SERIES

### PD2100 SERIES ELECTRONIC MARINE CONVERTER/CHARGERS WITH FOUR-STAGE CHARGING SYSTEM



#### Standard features on all models:

- Four-Stage Charging System – Patented Microprocessor constantly monitors battery voltage and automatically selects one of the four charging modes: BOOST, NORMAL, STORAGE or EQUALIZE.
- 3 Diode Isolated Outputs – Allows the Converter/Charger to charge three separate banks of batteries. Each output is capable of handling the full rated current of the charger.
- Patented Reverse Battery Protection – Prevents Converter/Charger from being damaged if the batteries are accidentally connected to the charger in reverse.
- Over and Under Voltage Protection – Prevents high voltage spikes and brownouts from damaging the Converter/Charger.
- Electronic Current Limiting – Limits the output current to the maximum rating of the charger to prevent over heating and damage caused by shorts or excessive loads.
- Variable Speed Intelligent Cooling Fan – Only runs as fast as required to maintain a more constant operating temperature inside the Converter/Charger. This feature reduces thermal stress caused by fans that cycle on and off.
- Programmable in the Field – PD2100 Series Intelli-Power Converter/Chargers are programmable in the field to provide optimum charging profiles for lead-acid, gel-cell or AGM batteries. See illustration on next page.
- Automatic thermal protection – reduces converter output to safe levels when unit temperature exceeds pre-set limits and protects converter from damage due to excessive heat.
- Series or Parallel Connection – Intelli-Power Converter/Chargers can be connected in series to provide a combination 12/24 Volt system or in parallel to provide more current.



Retail Display Package

## Converter/Charger Operating Status Digital Display Screen

Meter displays output voltage for all three outputs.  
With power off, it displays actual battery voltages.



### Digital Meter Displays: Current, Voltage, Operation Mode, Blown Fuse Indication, and Battery Type.

In-the-field programming the PD2100 Series for battery type is easy. Program ensures proper charge profile for lead-acid, gel-cell, or AGM batteries. Also has built-in self-test.

CHANGE BATTERY TYPE AS FOLLOWS:

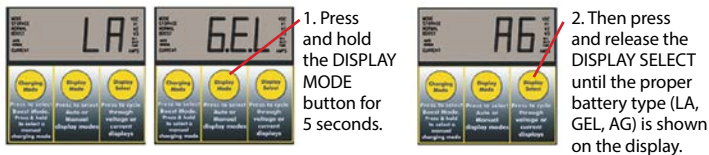

Microprocessor-controlled four stage charging system provides rapid recharge and long battery life.

**The Intelli-Power Four-Stage Charging System** – Provides optimum charging voltage at all times during the recharge cycle. Battery voltage is constantly monitored by the microprocessor, which automatically selects one of four operating modes:

**BOOST MODE** – Selected whenever the battery voltage is very low. Boost Mode provides a higher charging voltage to rapidly bring the battery up to 90% of full charge. The digital display will read BOOST when the charger is in this mode.

**NORMAL MODE** – Automatically selected once the battery reaches the 90% charged level. This lower voltage safely completes the charge and remains in this mode as long as the 12 Volt systems in the boat are being operated. The digital display will read NORMAL in this mode.

**STORAGE MODE** – Activated automatically when the 12 Volt systems are turned off and the battery has been fully charged for a period of 30 hours. The digital display will read STORAGE when in this mode.

**\*Exclusive! Equalize Mode** – Prevents battery stratification and power-robbing sulfation. When in the Storage Mode, the microprocessor automatically equalizes the battery by increasing the voltage from 13.2 Volts to 14.4 Volts for 15 minutes every 21 hours. This remixes the electrolyte mixture of water and sulfuric acid. Battery manufacturers recommend that Lead-Acid batteries be equalized every 30 days or 10 discharge cycles.

**What is battery stratification?** The electrolyte in lead-acid batteries is water and sulfuric acid. If a battery is not fully charged immediately after discharge, the sulfuric acid begins to form a layer of heavy concentration at the lower portion of the battery. Our exclusive Equalize Mode prevents stratification and sulfation.

\*NOTE: Gel-Cell and AGM batteries do not require an Equalize Mode.

## 80, 60, 50, 40, 30 & 20 Amp Models Available

**80 AMP** | OEM/Retail PD2180V  
Input: 105-130 VAC, 50/60 HZ, 1300 Watts  
Dimensions: 15.2"L x 7.8"W x 4.2"H  
Weight: 9.2 lbs.

**50 AMP** | OEM/Retail PD2150V  
Input: 105-130 VAC, 50/60 HZ, 900 Watts  
Dimensions: 10.9"L x 7.8"W x 4.2"H  
Weight: 6.3 lbs.

**30 AMP** | OEM/Retail PD2130V  
Input: 105-130 VAC, 50/60 HZ, 550 Watts  
Dimensions: 10.9"L x 7.8"W x 4.2"H  
Weight: 5.8 lbs.

**60 AMP** | OEM/Retail PD2160V  
Input: 105-130 VAC, 50/60 HZ, 1000 Watts  
Dimensions: 10.9"L x 7.8"W x 4.2"H  
Weight: 6.4 lbs.

**40 AMP** | OEM/Retail PD2140V  
Input: 105-130 VAC, 50/60 HZ, 650 Watts  
Dimensions: 10.9"L x 7.8"W x 4.2"H  
Weight: 5.9 lbs.

**20 AMP** | OEM/Retail PD2120V  
Input: 105-130 VAC, 50/60 HZ, 350 Watts  
Dimensions: 10.9"L x 7.8"W x 4.2"H  
Weight: 5.7 lbs.



Manufactured and Serviced  
in the USA



Covered by the following U.S.  
Patent: 7,782,002.

# RV Ceiling Lights

## 750 SERIES

OUR MOST POPULAR  
CEILING LIGHT MODEL

### Features:

- Available in single and double lens models.
- Easy touch large ON/OFF slide switch.
- Large lens & reflector design for excellent illumination.
- Snap-out lens design for quick bulb changes
- Three optional lens styles (retail models have white lenses)
- Heat-resistant, high impact polymer frame and lenses minimizes accidental damage.
- 1 year limited warranty.
- Replacement lenses available – see page 30.

### Retail Models:

**PD751WWV** Single Light, white frame and white lens – 12/carton  
**PD752WWV** Double Light, white frame and white lenses – 6/carton

### OEM Models:

**PD751WW** Single Light, white frame, white lens – 80/carton

### Specifications:

Switch: 2-Position slider  
Frame: Heat-resistant,  
high impact plastic  
Bulb(s): #1141 Automotive  
Candle Power: 21  
(42 on PD752 Double Light)  
Amps: 1.44  
(2.88 on PD752 Double Light)  
Voltage: 12 VDC  
Colors: White and Ivory

### Dimensions:

Single Light:  
6.375"L x 5.562"W x 1.625"H  
Double Light:  
11.437"L x 5.562"W x 1.625"H



PD752WWV



PD751WWV



Manufactured and Serviced  
in the USA





# RV Ceiling Lights

## 770 SERIES

LOWER PROFILE FOR RESTRICTED CLEARANCE APPLICATIONS

### Features:

- Available in single and double lens models.
- Wet Light model available for wet locations.
- Large lens & reflector design for excellent illumination.
- Snap-out lens design for quick bulb changes.
- Four optional lens styles.
- Heat-resistant, high impact polymer frame and lenses minimizes accidental damage.
- 1 year limited warranty.
- Replacement lenses available – see page 30.

**Retail Models:** (All 770 Series Lights are shipped with lens PD307)

**PD771WWV** Single Light, white frame w/switch, white lens – 12/carton

**PD772WWV** Double Light, white frame w/switch, double white lens – 6/carton

**PD772IWW** Double Light, ivory frame w/switch, double white lens – 6/carton

### OEM Models:

(Select lens style below. Add "Lens Style" selection letter to single or double light model no.)

<u>Single*</u>	<u>Double**</u>	<u>Description</u>
PD770W_		White frame, switchless
PD771W_	PD772W_	White frame with switch
PD771H_		Gray frame with switch
PD771I_		Ivory frame with switch

\*100 bulk/carton \*\*50 bulk/carton

### Specifications:

Switch: 2-Position (PD771 only),  
3-Position (PD772 Double Light)

Switchless: Pre-wired, color coded,  
ready for installation

Frame: Heat-resistant, high impact plastic

Bulb(s): #1141 Automotive

Candle Power: 21 (42 on PD772 Double Light)

Amps: 1.44 (2.88 on PD772 Double Light)

Voltage: 12 VDC

Colors: White and Ivory - (gray OEM only)

### Dimensions:

Single Light:  
6.563"L x 4"W x 1.563"H

Double Light:  
11.5"L x 4"W x 1.563"H

PD771WW



PD772WW



Manufactured and Serviced  
in the USA



# RV Ceiling Lights

## 780 SERIES

UNIQUE SNAP-OUT LENS  
AND REFLECTOR DESIGN

### Features:

- Available in single and double light models.
- Large lens and superior reflector design creates excellent illumination.
- Snap-out lens design for quick bulb changes.
- Shipped prewired and color coded for quick and easy installation.
- Two lens styles: white and optic.
- 1 year limited warranty.
- Replacement lenses available – see page 30.



PD782WSBC



PD781WSBC

### Retail Models:

**PD781WSBCV** Single Light, white frame with black switch, optic lens – 12/carton

**PD782WSBCV** Double Light, white frame with black switch, optic lens – 6/carton

### OEM Models:

**PD781WSBC** Single Light, white frame with black switch, optic lens – 100/carton

**PD781WSWC** Single Light, white frame with white switch, optic lens – 100/carton

**PD781WSBW** Single Light, white frame with black switch, white lens – 100/carton

**PD781WSWW** Single Light, white frame with white switch, white lens – 100/carton

**PD782WSBC** Double Light, white frame with black switch, optic lens – 50/carton

**PD782WSWC** Double Light, white frame with white switch, optic lens – 50/carton

### Specifications:

Switch: 2-Position rocker

Frame: Heat-resistant, high impact plastic

Bulb(s): #1141 Automotive

Candle Power: 21

(42 on PD782 Double Light)

Amps: 1.44 (2.88 on PD782 Double Light)

Voltage: 12 VDC

Colors: White

### Dimensions:

Single Light:

7" L x 4.5" W x 1.75" H

Double Light:

11.9" L x 4.5" W x 1.75" H



Manufactured and Serviced  
in the USA



# RV Ceiling Lights

## 790 SERIES

SWITCH AND SWITCHLESS  
MODELS AVAILABLE

### Features:

- The look of fluorescent without the cost!
- Available in single and double light models.
- Can be ordered with or without easy touch on/off slide switch (shown).
- Large lens and reflector design delivers excellent illumination.
- Snap-out lens design for quick bulb changes.
- Shipped prewired and color coded for easy installation.
- 1 year limited warranty.
- Replacement lenses available – see page 30.

### Retail Models:

**PD792WWV** Double Light, white frame with switch w/o Power Port, single white lens – 6/carton

### OEM Models:

(Select lens style below left. Add "Lens Style" selection letter to single or double light model no.)

#### Single\*      Description

PD791W\_      white frame with switch w/o Power Port

\*100 bulk/carton

### Specifications:

Switch: 2-Position

Frame: Heat-resistant, high impact plastic

Power Port: Optional on PD791 and PD792

Bulb(s): #1141 Automotive

Candle Power: 21(42 on PD792 Double Light)

Amps: 1.44 (2.88 on PD792 Double Light)

Voltage: 12 VDC

Color: White

### Dimensions:

Single Light:

7.4"L x 4.5"W x 1.75"H

Double Light:

12.8"L x 4.5"W x 1.75" H

Bunk Light:

7"L x 4.5"W x 3"H



Single Light

Double Light/Single Lens  
This 12 Volt double light  
is ideal for low-clearance  
applications.



Manufactured and Serviced  
in the USA



# 12V LED Lighting for RV's

## 770 / 790 SERIES

SHIPPED PREWIRED AND COLOR CODED  
FOR QUICK AND EASY INSTALLATION

### 770 Series LED 12V Ceiling Lights

*Lower profile for restricted clearance applications.*

#### Features:

- Available in single and double lens models.
- Large lens for excellent illumination.
- Snap-out lens design.
- Heat-resistant, high impact polymer frame and lenses minimizes accidental damage.
- 1 year limited warranty.

**PD771WWLEDV** Single Light, white frame w/switch, white lens – 12/carton

**PD772WWLEDV** Double Light, white frame w/switch, double white lens – 6/carton

#### Dimensions:

**PD771WWLEDV:** 6.563"L x 4"W x 1.563"H

**PD772WWLEDV:** 11.5"L x 4"W x 1.563"H

#### Specifications:

Switch: 2-Position (PD771WWLEDV)  
3-Position (PD772WWLEDV)

Switchless: Pre-wired, color coded, ready for installation

Frame: Heat-resistant, high impact plastic

Bulb(s): LED

Watts: 2.5 (Single), 5 (Double)

Lumens: 205 (Single), 410 (Double)

Voltage: 12 VDC

Colors: White

**Saves 79% on power  
usage compared  
to incandescent.**



PD771WWLEDV

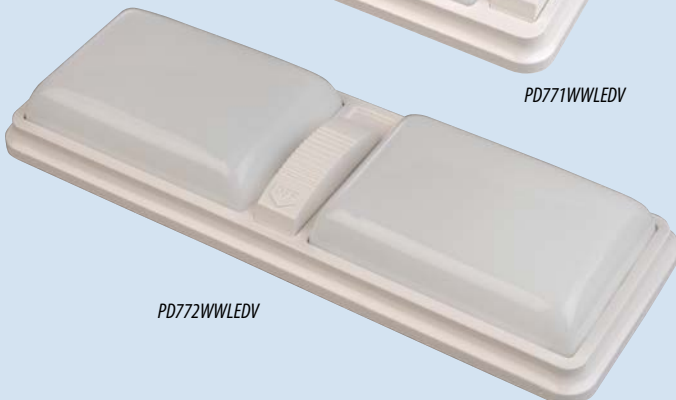

PD772WWLEDV

### 790 Series LED 12V Ceiling Lights

*Switch and switchless models available.*

#### Features:

- Available in single and double light models.
- Large lens for excellent illumination.
- Snap-out lens design.
- Heat-resistant, high impact polymer frame and lenses minimizes accidental damage.
- 1 year limited warranty.

**PD791WWLEDV** Single Light, white frame w/switch, white lens – 12/carton

**PD792WWLEDV** Double Light, white frame w/switch, double white lens – 6/carton

#### Dimensions:

**PD791WWLEDV:** 7.4"L x 4.5"W x 1.75"H

**PD792WWLEDV:** 12.8"L x 4.5"W x 1.75"H

#### Specifications:

Switch: 2-Position

Frame: Heat-resistant, high impact plastic

Bulb(s): LED (non-replaceable)

Watts: 2.5 (Single), 5 (Double)

Lumens: 205 (Single), 410 (Double)

Voltage: 12 VDC

Colors: White



PD792WWLEDV



PD791WWLEDV



# 12 Volt Lights

## READING & CONVENIENCE

### 12 Volt Reading Lights

*Perfect for closeup reading or other work requiring excellent illumination.*

#### Features:

- Full 75° extension and 300° rotation puts the light where you need it most.
- Can also be used to create dramatic lighting accents.
- Full bulb sockets assure positive electrical contact.
- Metal reflector intensifies light and dissipates heat.

#### Retail Models:

PD787-26V White, Black Bezel — 6 View Packs/Carton

PD787-36V Ivory, Black Bezel — 6 View Packs/Carton

#### OEM Models:

PD787-26 White, Black Bezel — 20/Carton

PD787-36 Ivory, Black Bezel — 20/Carton

PD787-46 Grey, Black Bezel — 20/Carton

#### Specifications:

Switch: 2-Position Rocker  
Bulb: #1141 Long-life Automotive  
Amps: 1.44

#### Dimensions:

Swivel Out: 5"L x 3.25"W x 4"H  
Tilted Out: 5"L x 3.375"W x 5.375"H



### 12 Volt Convenience Lights

*Perfect for illuminating closets, cabinets, or under the sink.*

#### Features:

- Automatic door-activated on/off switch.
- Low profile design with protective lens.
- Pre-wired and color coded for easy installation.
- Versatile mounting options.
- High impact plastic body with heat-dissipating design.

#### Retail Models:

PD210-111V 1 Amp, Brown — 20 View Packs/Carton

#### OEM Models:

PD210-111 1 Amp, Brown — 40/Carton

#### Specifications:

1 Amp Bulb: #561 Automotive

#### Dimensions:

4.125"L x 3.5"W x 2"H



Manufactured and Serviced  
in the USA



# RV Ceiling Lights

## REPLACEMENT LENSES

### Lens Styles – OEM replacement lenses fit all 750 Series lights



**810590**  
White  
80 bulk/carton  
Lens Style "W"



**810527**  
Optic  
80 bulk/carton  
Lens Style "O"



**807673**  
Prismatic  
80 bulk/carton  
Lens Style "C"



**PD305**  
White Lens  
2/Bag, 50/Carton



**PD306**  
Prismatic Lens  
2/Bag,  
50/Carton



**PD304**  
Optic Lens  
2/Bag, 50/Carton

### Lens Styles – OEM replacement lenses fit all 760 Series lights



**810590**  
White  
80 bulk/carton  
Lens Style "W"



**810527**  
Optic  
80 bulk/carton  
Lens Style "O"



**807673**  
Prismatic  
80 bulk/carton  
Lens Style "C"



**PD305**  
White Lens  
2/Bag, 50/Carton



**PD306**  
Prismatic Lens  
2/Bag,  
50/Carton



**PD304**  
Optic Lens  
2/Bag, 50/Carton

### Lens Styles – OEM replacement lenses fit all 770 Series lights



**807877**  
White 100  
bulk/carton  
Lens Style  
"W"



**809928**  
Clear Optic  
Starburst Style  
100 bulk/  
carton Lens  
Style "TT"



**809902**  
Clear Optic  
Skylight Style  
100 bulk/  
carton Lens  
Style "RR"



**807882**  
Clear Optic  
Solar Style  
100 bulk/  
carton Lens  
Style "C"



**809511**  
Clear Wet  
Light 100  
bulk/carton  
Lens Style "S"



**PD307**  
White  
2/Bag,  
50/Carton



**PD310**  
Clear Optic  
Starburst  
Style  
2/Bag,  
50/Carton



**PD309**  
Clear Optic  
Skylight  
Style  
2/Bag,  
50/Carton



**PD308**  
Clear Optic  
Solar Style  
2/Bag,  
50/Carton

### Lens Styles for 780 Series lights



**810358**  
Optic Lens  
100 bulk/carton



**810431**  
White Lens  
100 bulk/carton



**PD311**  
Optic Lens  
2/Bag,  
50/Carton



**PD312**  
White Lens  
2/Bag,  
50/Carton

### Lens Styles – OEM replacement lenses fit all 790 Series Lights



**810844**  
Single optic  
lens –  
100 bulk/  
carton  
Lens Style "R"



**810867**  
Double white  
lens –  
50 bulk/  
carton  
Lens Style "W"



**810868**  
Single white  
lens –  
100 bulk/  
carton  
Lens Style "W"

#### Retail Replacement Lenses:

**PD316** Double, White,  
1/Bag, 50/Carton

**PD313** Single, Optic,  
2/Bag, 50/Carton

**PD315** Single, White,  
2/Bag, 50/Carton

# RV Lighting Accessories

## REPLACEMENT BULBS

EXTENSIVE INVENTORY OF REPLACEMENT BULBS & FUSES  
FOR ALL CURRENT AND MANY EARLIER LIGHTING PRODUCTS

### Vanity & Ceiling Lights (OEM only)

*Can be ordered in retail packs or bulk.*

- 107006** Soft White Vanity Bulbs — 25 bulk/carton
- 109642** Clear Replacement Vanity Bulbs — 25 bulk/carton
- 106648** Replacement Bulb for Ceiling Lights (#1141) — 100 bulk/carton



### Retail Packaging



**PD303** White Vanity Light Bulbs (2/package) — 6 blister packs/carton



**PD318** Clear Vanity Light Bulbs (2/package) — 6 blister packs/carton



**PD302** Ceiling Light Bulbs (2/package) — For ceiling lights (#1141) 24/carton

### Convenience Lights (OEM only)

*Can be ordered in bulk only.*

- 107076** Replacement 1 Amp Bulb for Convenience Light (#561) — 100 bulk/carton
- 107338** Replacement 1/2 Amp Bulb for Convenience Light (#563) — 100 bulk/carton



### 30 Amp Replacement Fuses

**108882** Special 30 Amp UL Replacement Fuse for all Intelli-Power Series Converter/Chargers.

Order the exact quantity you need.

