

BODYSPA RV

EASY INSTALLATION INSTRUCTIONS

STEP 1

Remove your existing shower head. To remove, turn the existing shower head in a counterclockwise direction.



STEP 2

Remove any remnants of old plumber's tape and flush out shower pipe for 5 to 10 seconds.



STEP 3

Wrap plumber's tape clockwise 3 or 4 turns around threaded end of shower arm.



STEP 4

In a clockwise direction, screw end of hose to the taped portion of the shower arm. Hand tighten only.

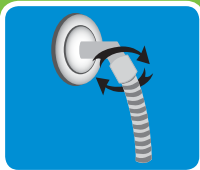

STEP 5

Attach wide end of SmartPause® valve to base of the handheld shower and hand tighten. Attach hose to opposite end of the SmartPause® valve.

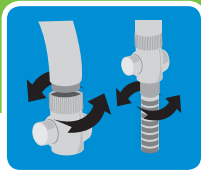

STEP 6

Attach double stick tape provided to back of holder and press firmly to clean, dry shower wall. Place your new handheld shower head into holder.

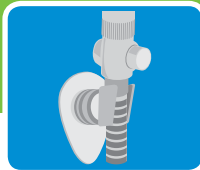

NO TOOLS
NEEDED

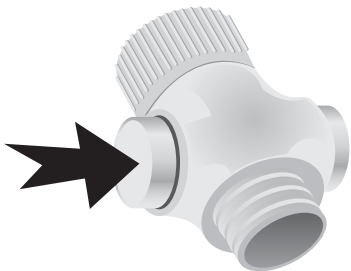

USING THE SMARTPAUSE VALVE

Located at the base of the BodySpa® wand, the SmartPause® valve allows you to pause your shower while you lather up.

To pause the shower spray: Gently push the button on the SmartPause® valve from left to right to pause the shower's flow. To resume flow, simply push button back to the left.