



GIRARD PRODUCTS. LLC.

TANKLESS WATER HEATER Model GSWH-2
INSTALLATION MANUAL ADDENDUM for after Market Installations

REPLACEMENT OF AN ATWOOD 6 GA. UNIT
DOOR/FLANGE ASSEMBLY - Part #2GWHDA6

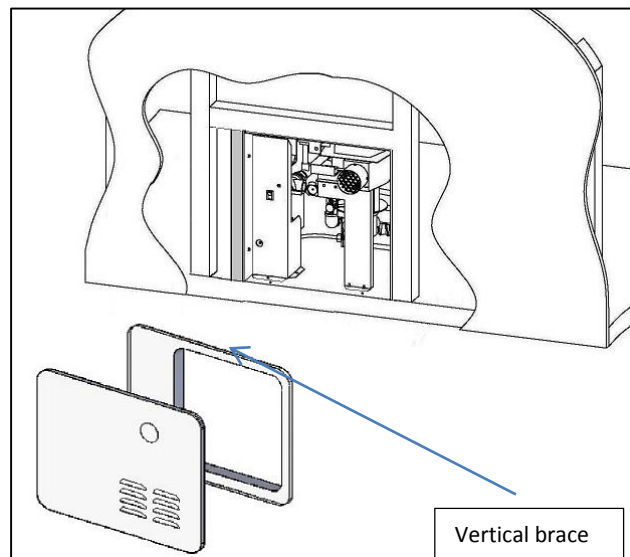

Fig. 1

The existing cut out for a 6 gal Atwood water heater measures 16 1/4" (W) by 12 5/8" (H). The cut out needed for your GSWH-2 is only 13" by 13" and its flange **MUST** be supported on all sides by a wooden frame so that it may be mounted rigidly with #8 3/4" flat head screws. The flange will fit vertically into the existing opening, but a horizontal gap of 3 1/2" will be left between the new flange and the side of the opening. A properly cut piece of 2" by 2" must be added as a vertical brace located at 13" from the right edge of the cut out. (See Fig. 1)

Please refer to the GSWH-2 Owner's Manual for information on how to complete the Water Heater installation.

NOTICE

The Girard 2GWHDA6 & 2GWHDA10 Conversion Door Kits do not cover the corners of the Atwood 6 & 10 gallon water heater with a FLUSH MOUNT Door. The installer will need to make modifications/fabricate to cover the corners. Prior inspection is recommended and quote the customer for any additional labor and/or materials.

This issue is only applicable to the Atwood *Flush Mount Doors*. No modification/fabrication is needed if a Suburban *Flush Mount Door*.

TANKLESS WATER HEATER Model GSWH-2
INSTALLATION MANUAL ADDENDUM for after Market Installations

**REPLACEMENT OF AN ATWOOD OR A SUBURBAN 10 GA. UNIT
DOOR/FLANGE ASSEMBLY - Part #2GWHDA10**

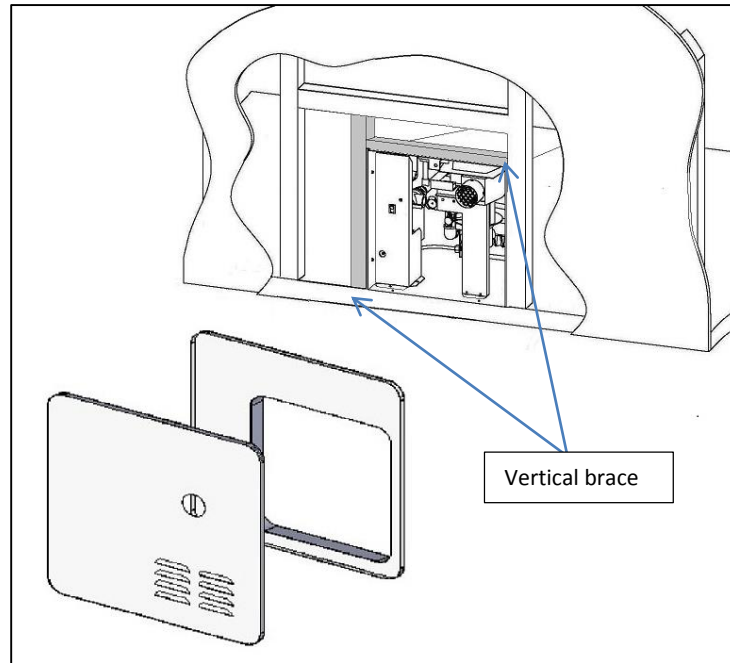

Fig.2

The existing cut out for a 10 gal Atwood water heater measures 16 ¼" by 15 ¾" and for a 10 gal Suburban unit measures 16 ¼" by 16 ¼".

The cut out needed for your GSWH-2 is only 13" by 13" and its flange **MUST** be supported on all sides by a wooden frame so that it may be mounted rigidly with #8 ¾" flat head screws.

A horizontal gap of 3 ½" and a vertical gap of 3" will be left between the new flange and the sides of the opening.

Two properly cut piece of 2" by 2" must be added as a vertical brace located at 13" from the right edge and 13" from the bottom edge of the cut out. (See Fig. 2).

Please refer to the GSWH-2 Owner's Manual for information on how to complete the Water Heater installation.

NOTICE

The Girard 2GWHDA6 & 2GWHDA10 Conversion Door Kits do not cover the corners of the Atwood 6 & 10 gallon water heater with a FLUSH MOUNT Door. The installer will need to make modifications/fabricate to cover the corners. Prior inspection is recommended and quote the customer for any additional labor and/or materials.

This issue is only applicable to the Atwood *Flush Mount Doors*. No modification/fabrication is needed if a Suburban *Flush Mount Door*.