



INSTRUCTIONS – UNIVERSAL TRIM KIT FOR DELTA®

* ADDITIONAL INFORMATION

To properly install this product, a 3-1/2 inch round opening in the wall is required for the offset portion of the faceplate trim to recess in, or else it will protrude from the wall.

Before you begin

FOR QUICK & EASY
3D ASSEMBLY INSTRUCTIONS



Download the
FREE App



1

Removal of Old Trim Figure 1

1. Shut off water supply to tub/shower faucet. This may require shutting off the main water supply to the house or facility. Once the water supply is shut off, turn on the faucet to allow the water pressure to be released. Then reclose the faucet.
2. Remove the index button (A) from the old handle (C). Remove handle screw (B) and handle (C).
3. Note which valve type is being used. (Fig. 2). Note whether the valve uses a diverter (H).
4. Remove dome nut assembly (D). Remove faceplate screws (E). Remove faceplate (F). Slide off body sleeve (G).

FIGURE 1

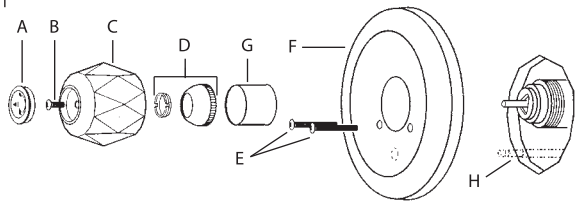

3

Installation of Faceplate* Figures 3, 4, 5, 6 & 7

1. Install new sleeve by sliding over valve (Fig. 3).
Note: Valve Type A and Type B use the same sleeve (A). Valve Type C uses the larger sleeve (B).
2. For Valve Type C, skip to step 3. Valve Types A and B ONLY: install new dome nut (C) and dome bushing (D) (Fig. 4) and hand-tighten only. Dome bushing can be adjusted if stem is loose.

FIGURE 5
Valve Type A/B

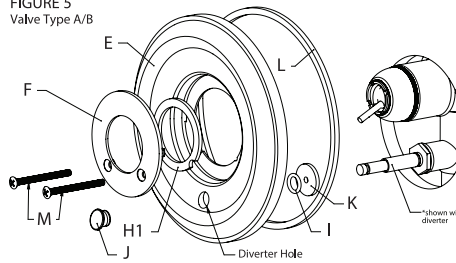

FIGURE 3

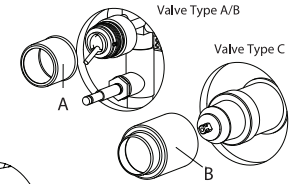
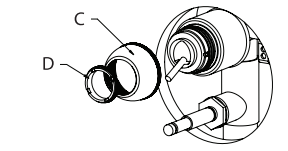
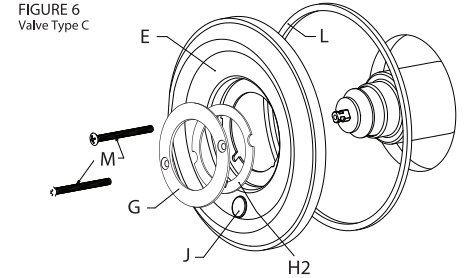

FIGURE 4
Valve Type A/B



3. Locate the faceplate (E). **NOTE:** Faceplate insert (F) is preassembled in faceplate (E). If the valve uses a diverter, remove the "O" Ring (I) on the back of the face plate and remove the diverter plug (J) (Fig. 5). Using the diverter foam insert (K), remove the backing paper and adhere to the back of the faceplate (E) where the diverter will pass through. If diverter is not used, do not remove the diverter plug (J) and "O" Ring, the diverter foam (K) is not required and proceed to Step 4.

FIGURE 6
Valve Type C



2

Correct Valve Identification Figure 2

1. After the old trim has been removed, refer to Fig. 2 to determine correct valve.
Valve Type A 600 Series with #212 Ball uses a stem that is diamond shaped on the end.
Valve Type B 600 Series with #70 Ball uses a stem that is round on the end.
Valve Types A & B operate by rotating the handle up to turn on the water.
Valve Type C Monitor® 13/14 Series uses a stem that is round with two flat sides.
Valve Type C operates by turning the handle right to left to turn on the water.
2. Note whether the valve uses a push button diverter to control the water to the shower head.

FIGURE 2

VALVE TYPE A
600 Series with #212 Ball
shown with diverter

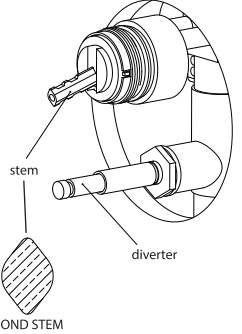

VALVE TYPE B
600 Series with #70 Ball
shown without diverter

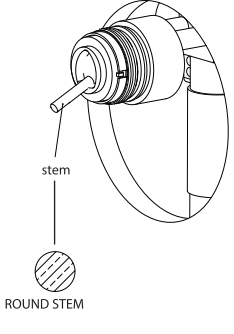

VALVE TYPE C
Monitor® 13/14 Series
shown without diverter

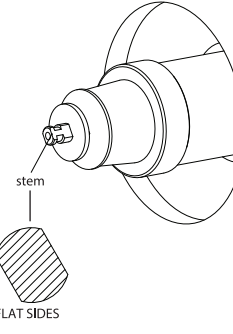

4. Choose the correct faceplate insert:
Valve Types A & B use the same faceplate insert (F) (Fig. 5).
Valve Type C uses the faceplate insert (G) with the larger inner opening (Fig. 6).

Using the foam insert (H1 or H2) included (note two different sizes), remove backing paper and adhere to the back of the correct faceplate insert. Snap the faceplate insert (F or G) into the faceplate (E). Firmly press faceplate insert into faceplate. **Note:** The tabs on the faceplate insert will align with slots on the faceplate.

FIGURE 7

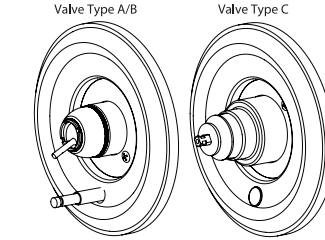

5. Place faceplate gasket (L) into the groove on the back of the faceplate (E). Slide faceplate assembly over the sleeve. Make sure the diverter hole is toward the bottom (Fig. 7). Press faceplate assembly against the wall, making sure not to dislodge the faceplate insert. Secure faceplate assembly to the valve body using included screws (M). Do not over-tighten.

A Handle Adapter for Valve Types A or Type B Figure 8

1. Locate handle adapters (N/O) for Valve Type A & B (Fig. 2). Determine which adapter to use based on which will fit on the valve stem.
2. Partially thread set screw (P) in to handle adapter (N/O) that fits on the valve stem (Fig. 8).
3. Slide Handle Adapter on to valve stem, making sure that the valve stem is fully seated in the adapter. Align the handle adapter to where the set screw (P) is pointing down. Secure the set screw (P) to the valve stem.

FIGURE 8

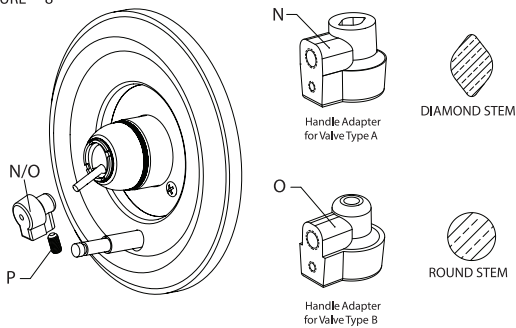

4

Installation of Handle Adapter

B Handle Adapter for Valve Type C Figure 9

1. Locate the handle adapter (Q) for Valve Type C (Fig. 2).
2. Slide the handle adapter (Q) for Valve Type C on the valve stem, making sure that the adapter is oriented in the downward position as shown. Do NOT secure handle adapter (Q) to valve stem.

FIGURE 9

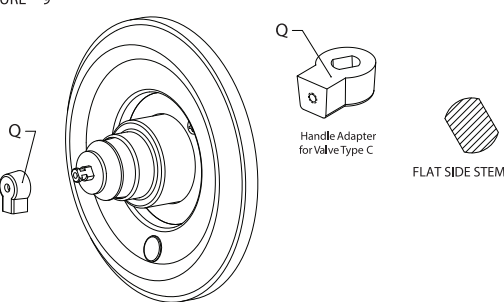

A For Plastic Handle

(Valve Types A, B and C) Fig. 10

1. Place clear plastic handle (R) over handle adapter. For Valve Type A or B, use screw (S) and lock washer (T) to secure handle (R) to handle adapter. For Valve Type C, screw (S) will screw directly in to stem.
2. Snap handle button (U) to handle (R).

FIGURE 10

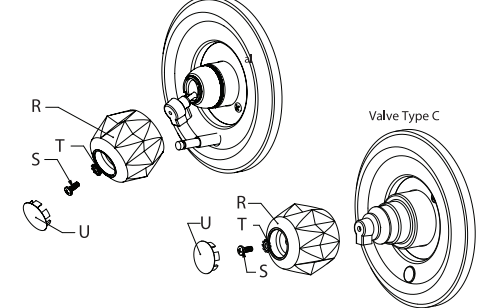

B For Metal Lever Handle

(Valve Types A and B) Fig. 11

1. Place metal lever handle (V) over handle adapter (N/O). Lever should point downward. Using hex screw (W), pass through handle (V) and screw in to handle adapter (N/O) from the under side of the handle. Secure in place.

(Valve Type C) Fig. 11

1. Using screw (S) and lock washer (T), secure handle adapter (Q) to valve stem.
2. Place metal lever handle (V) over handle adapter (Q). Lever should point downward. Using hex screw (W), pass through handle (V) and screw in to handle adapter (Q) from the under side of the handle. Secure in place.

5

Installation of Handle Choose Your Desired Handle

FIGURE 11

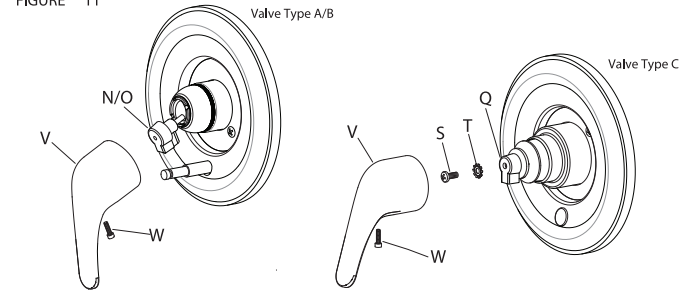

Parts List – Universal Trim Kit For Delta®

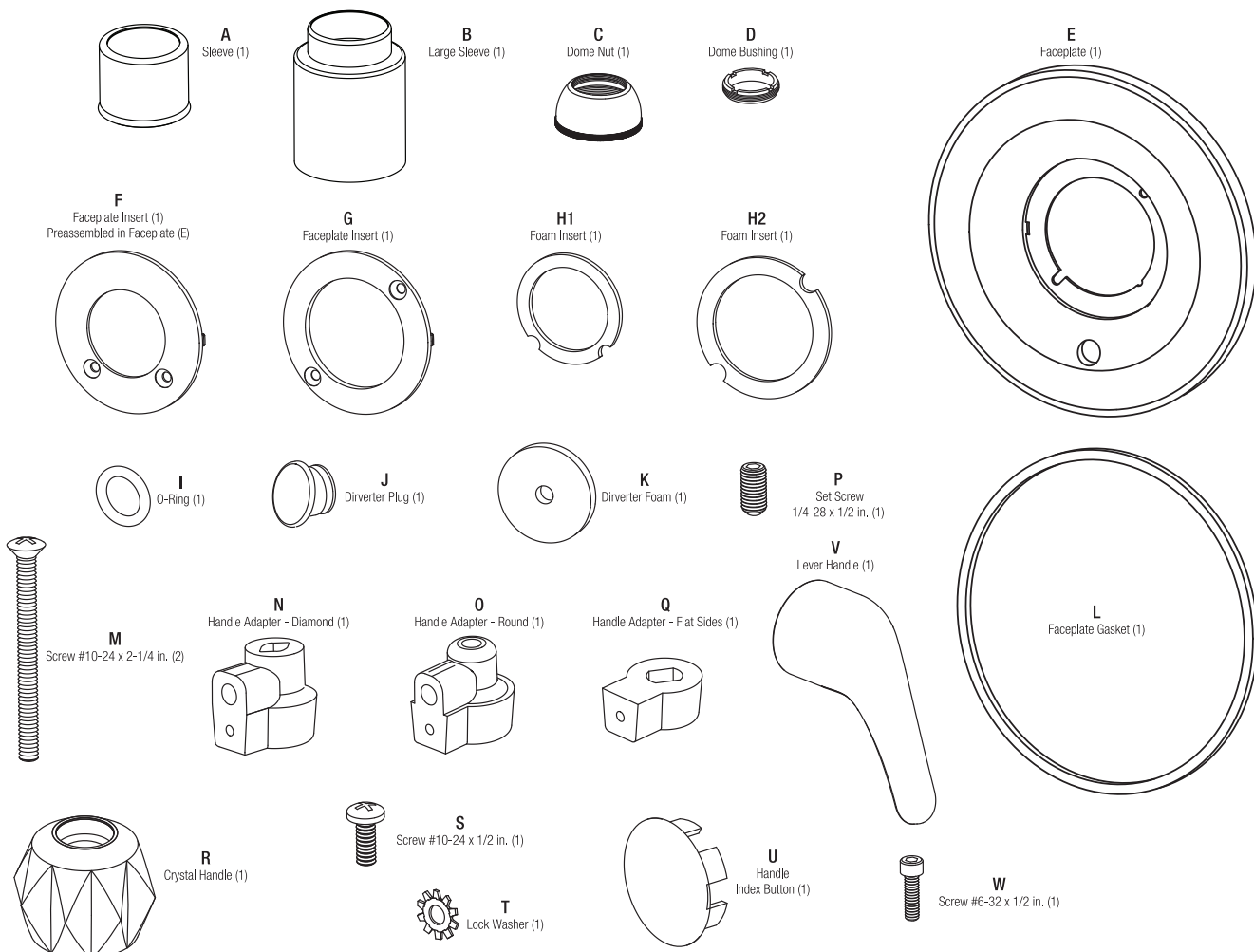

Part #	Qty. Included	Item
A	1	Sleeve
B	1	Large Sleeve
C	1	Dome Nut
D	1	Dome Bushing
E	1	Faceplate
F	1	Faceplate Insert
G	1	Faceplate Insert
H1	1	Foam Insert
H2	1	Foam Insert
I	1	O-Ring
J	1	Diverter Plug
K	1	Diverter Foam
L	1	Faceplate Gasket
M	2	Screw #10-24 x 2-1/4 in.
N	1	Handle Adapter - Diamond
O	1	Handle Adapter - Round
P	1	Set Screw 1/4-28 x 1/2 in. (1)
Q	1	Handle Adapter - Flat Sides
R	1	Crystal Handle
S	1	Screw #10-24 x 1/2 in. (1)
T	1	Lock Washer
U	1	Handle Index Button
V	1	Lever Handle
W	1	Screw #6-32 x 1/2 in. (1)

Learn more about home bath and faucets we have.