

# CLEAR-IT DRAIN OPENER & WATER JET

## INSTALLATION INSTRUCTIONS

**CONTENTS:** Hose, Male/Female Aerator, Aerator Large Washer, Garden Hose Adapter, Garden Hose Washer

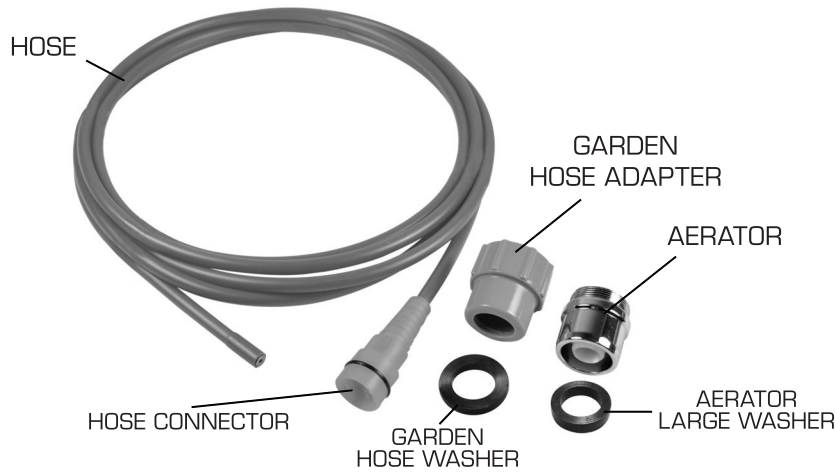

If aerator becomes disassembled, reference the image for component installation sequence

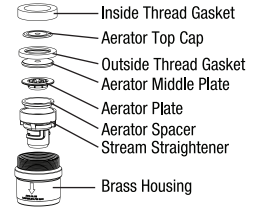

### GARDEN HOSE INSTALLATION:

NOTE: Aerator is not needed for garden hose installation

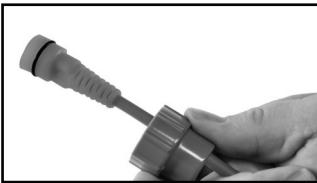

1. Locate the gray garden hose adapter. Remove the black garden hose washer from garden hose adapter. Feed garden hose adapter (threaded side first) onto green hose starting from the sprayer tip until reaching the hose connector. Pull up on garden hose adapter to lock into place on hose connector.



2. Insert black garden hose washer inside gray garden hose adapter. Thread garden hose adapter onto end of garden hose. Hand tighten only.

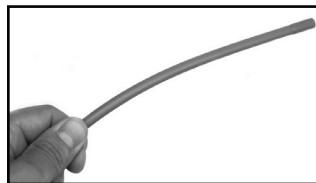

3. Firmly grasp hose near sprayer tip and face sprayer away from body. Turn on the water slowly to test for leaks. NOTE: Wear safety glasses while operating. If hose slips from grasp, turn off water at faucet source immediately.

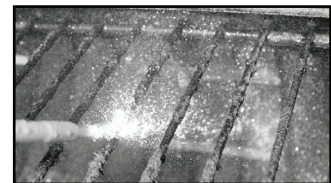

4. Angle sprayer tip toward object to clean and blast away dirt and grime.

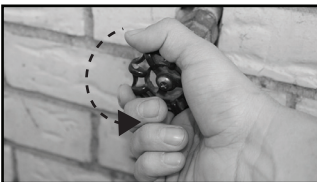

5. Turn off water at source after use.



6. To remove hose, unthread garden hose adapter from end of garden hose.

## CLEAR-IT DRAIN OPENER & WATER JET

**KITCHEN SINK INSTALLATION:** For 15/16"-27 Male or 55/64"-27 Female Aerators

NOTE: Garden hose adapter and garden hose washer are not needed for faucet installation.



1. Remove the old aerator and washer from your faucet spout. NOTE: If using an adjustable wrench or pliers, cover aerator with a cloth to prevent scratching.



2. Locate the new aerator. If the faucet spout is threaded on the outside (male threads), remove the thick rubber washer, while leaving the thin rubber washer and disk inside the new aerator. If the faucet spout is threaded on the inside (female threads), do not remove washers inside the new aerator. Tighten up to ¼ turn past hand tight using pliers with a cloth to prevent scratching. NOTE: The aerator can remain permanently attached to faucet.



3. Locate the green hose and align the arrow markings on the green hose connector with aerator. Gently push green hose connector up into aerator and turn a quarter-turn counter-clockwise to lock hose into place. Lightly tug on connector to ensure it is locked in place. NOTE: If hose is difficult to push into aerator, lubricate o-ring on hose connector.



4. Firmly grasp hose near sprayer tip and face sprayer towards sink. Turn on the water slowly to test for leaks and turn off water after test. NOTE: Wear safety glasses while operating. If hose slips from grasp, turn off water at faucet source immediately.



5. Slowly feed hose down drain until clog is reached. Slowly turn on water to blast away clog. May take between 5-10 minutes to remove clog. NOTE: If water begins to rise in sink, feed more of the tubing into drain in a push/pull motion.



6. Turn off water and remove hose from drain. NOTE: If clog remains, repeat steps 5-6 until clog is removed.



7. To release hose connector from aerator, gently push up on hose connector and turn a quarter turn clockwise to release from aerator.

### ⚠CAUTION:

- Never leave hose unattended when water is turned on.
- Always turn water off before detaching hose.
- Inspect product before each use; Do not use if damaged.
- Never direct spray at people or animals.
- Wear safety glasses while operating.
- When using for cleaning, test on inconspicuous area to ensure that stream does not damage item.