

PermaPRO™

Instructions: PermaPRO™

⚠ WARNING!

Cover for storage use only.

Do not occupy the RV while cover is on the RV.

Do not run the RV engine with the cover on.

⚠ WARNING!

Installation is best done with two people and on most RVs requires working from the roof of the RV. **Never install on a windy day or when the roof is slippery or wet. Please take care when you are on a ladder or the roof.**

Be sure that your helper does not pull the cover while you are on top of the RV.

CAUTION

Installation and removal is safer and easier when done by two people. Cover or tape any sharp edges on your RV that could wear against your RV cover. Be sure to lower any roof antennas.

Tools

Some radio antennas may need to be unscrewed; usually with a Phillips head screwdriver. Your cover will fit over flexible or flat antennas and AC units.

Installation

1. With another person lift the cover to the roof.

2. Carefully climb up on the roof and take your cover out of its storage bag (Fig. 1). Place the rolled-up cover at the front center of the roof and unroll down the center of the RV toward the back (Fig. 2).

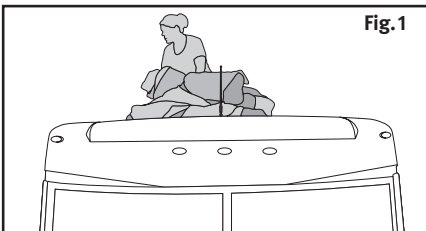

3a. Starting at the front, unfold your cover from the center outwards. Continue unfolding the cover as you work toward the back, letting it fall over the sides of your RV (Fig. 3). Make sure the corners of

the cover are at the corners of your RV.

3b. For travel trailer, 5th wheel and toy hauler RVs finish by zipping all the panels closed on your cover then pull the elasticized corners down over the bumper(s) of your RV.

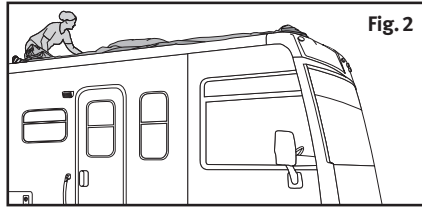

4a. For class A and class C RVs

Your cover is equipped with triple zipper pulls on the front side panels (Fig. 4). These extra zipper pulls allow the cover to fit RVs with mirrors that do not fold against the RV. Zip all three zipper pulls down to the mirror height, then zip the bottom zipper to the bottom of the cover. Create an opening at the mirror height by zipping the top zipper up slightly and the center zipper down slightly. Slip the opening over the mirror and close the top and bottom zippers around the mirror post. Finish by zipping all the panels closed on your cover then pull the elasticized corners down over both bumpers of your RV.

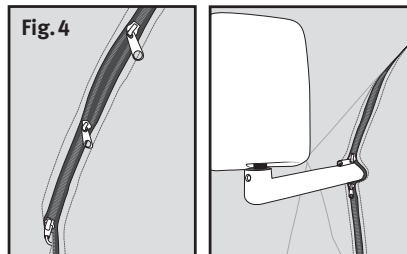
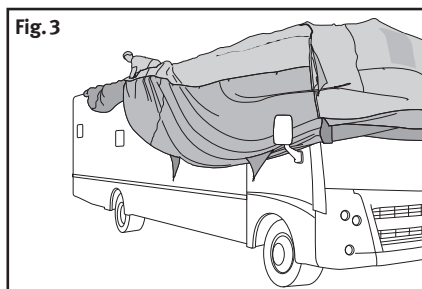

4b. For 5th wheel RVs

Connect and loosely tighten the tension panel strap across the bottom front of the nose of your 5th wheel (Fig. 5). Then connect the rip-and-grip tabs that fold in on either side just under the nose of your 5th wheel (Fig. 6). Adjust and tighten straps as necessary for a snug fit.

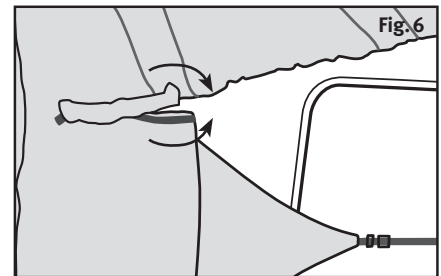
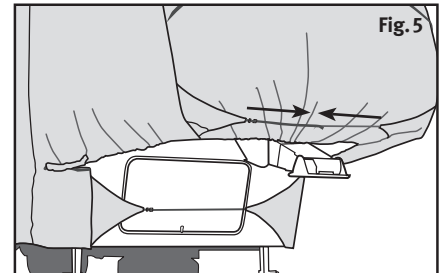

4c. For toy hauler RVs

If your Toy Hauler is a trailer type skip to step 5. If your Toy Hauler is a 5th wheel type, Unzip the second zipper from the front up to the bottom of the overhang on both sides. Buckle a strap to the upper tension panel (Fig. 7) (A) on the side of the overhang and bring it across to the other side and buckle. Repeat with the lower tension panels (Fig. 7) (B).

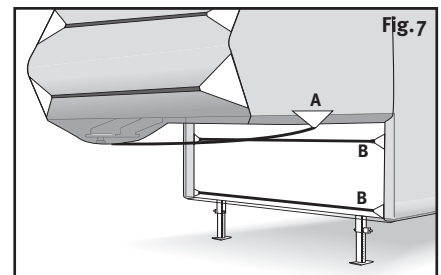

Instructions: PermaPRO™

5. For all RVs

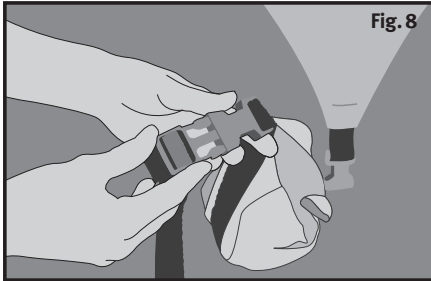

Included with your cover is a toss bag to help you attach the straps under your RV. Before you begin fill your toss bag with rocks or something of equal weight equivalent. Clip the toss bag to the buckle strap attached to the tension panel (Fig 8). Now toss the bag under your RV to the buckle on the opposite side (Fig 9). Unclip the strap from the bag and buckle the bag to the next strap. Repeat with the remaining straps.

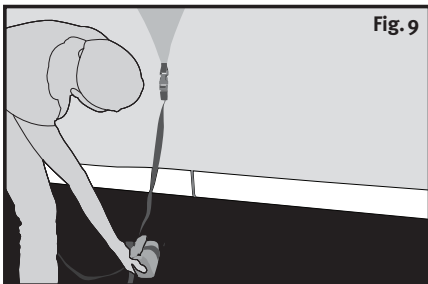

6. Adjust the strap length on the tension panels across the front and back to fit your RV. Don't over tighten—the straps should be snug, not drum tight.

The sides of your cover can be unzipped for access to the doors. The panels can be rolled up and held in place with the rip-and-grip straps toward the top of each panel.

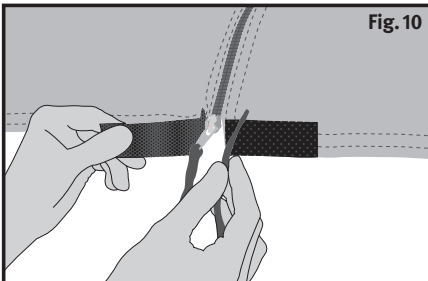

Your cover is equipped with extra long zipper pulls. To secure the zipper pulls so that they do not drag on the ground bring the ends of the zipper pulls up and tuck them into the rip-and-grip closure located at the base of the zipper along the hem (Fig. 10).

Use and Storage

A handy storage bag is provided. The bottom of your bag unzips and expands to make packing easier.

Note: For easier packing and re-installing fold and roll tightly before packing in storage bag.

Never store a wet cover in the storage bag or confined area as the cover can be damaged by mildew.

Care

Spot clean with water, a mild soap and a sponge. Don't use abrasive cleaners or brushes.

