

Dryer Venting Components

Flexible vents

Tubos flexibles



Close elbow

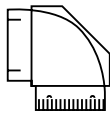

Wall offset elbow



Dryer offset elbow

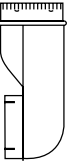

90° elbow

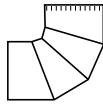

Clamps

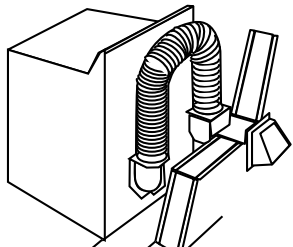
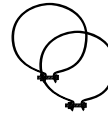

Loop Systems

A typical installation includes one elbow attached to dryer and one elbow attached to vent hood with flexible metal vent connecting the two elbows.

Clamps may be needed for fittings that do not snap together.

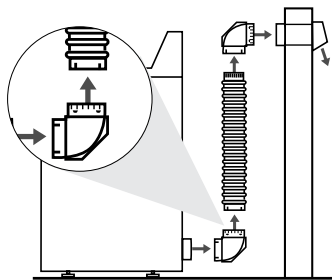

Airflow

Connections are made by placing the smaller diameter fitting (crimped) into the larger diameter fitting (slotted) in the direction of the airflow. Continue this throughout the installation.

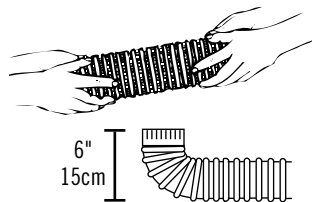

Stretch flexible duct gently with both hands to the desired length.

90° turns use up about 12" length of vent and take up 6" of space.



6"
15cm

Plain End Duct

Use gloves. Cut metal ends are sharp. Ends of duct may need to be treated. Duct should fit snugly over the dryer pipe and the wall pipe. Flattening out the edges of the duct may assist in fit.

To treat duct: Pull out ribs of duct to full extension so that wall outlet pipe will slide into the duct.

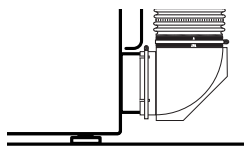
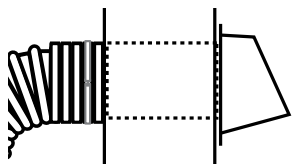

To connect the elbow to the dryer, position a clamp so that it covers the slot in the elbow. Slide the elbow over the dryer exhaust pipe. Tighten clamp.

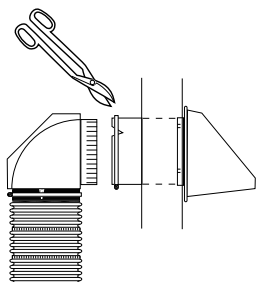

When connecting to a wall pipe, cut a 1" long slit in tailpipe. Position a clamp so it covers the slit in the vent tailpipe. Insert crimped fitting into tailpipe. Tighten clamp.

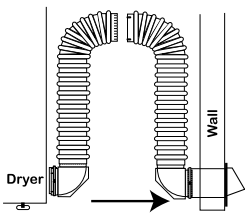

Guide dryer into position. Joints on elbows swivel to allow motion.

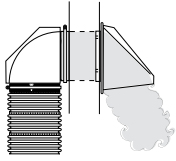

Check installation by inspecting airflow outside. Verify hood flapper is pushed fully open when the dryer is turned on.

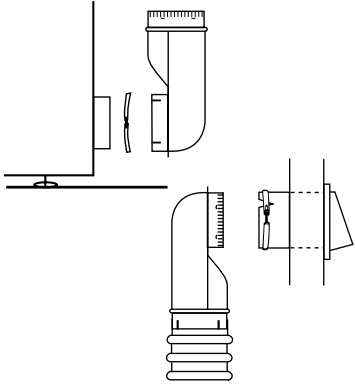

Offset Elbows

Offset elbows allow tailpipes to protrude up to 2" (5 cm) without trimming. Use only one offset elbow per installation.

The dryer offset elbow can also be used to fit over wall tailpipes which are too small for the wall offset elbow to fit into. In this case, do not slit wall tailpipe.

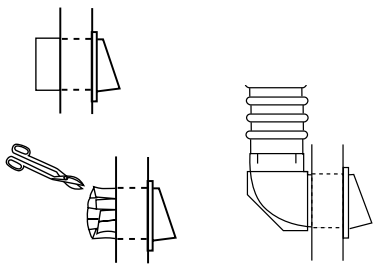

Trim tailpipe for close clearance

For close clearance, cut vent tailpipe so it extends only 1/2" (1.3 cm) from the wall.

Cut slits every 1/2" (1.3 cm) around the tailpipe.

Bend tabs flat against wall.

Push the crimped fitting of elbow completely into vent tailpipe.

Additional installations

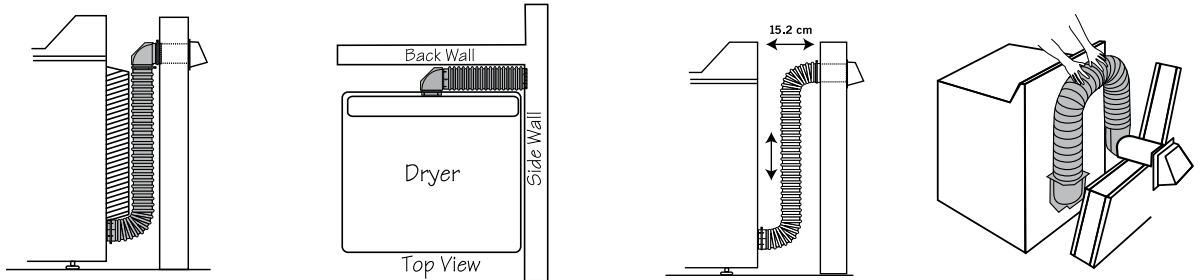

! WARNING! IMPORTANT SAFETY INSTRUCTIONS • SAVE THESE INSTRUCTIONS

To reduce the risk of fire or injury to persons, follow basic precautions, including the following:

1. For use with clothes dryers only, do not use for any other purposes.
2. Keep area around the exhaust opening and adjacent areas free from the accumulation of lint, dust, and dirt.
3. The interior of the exhaust duct should be cleaned periodically (at least once a year) by qualified service personnel.
4. A gas dryer should always be vented outdoors.
5. Regularly inspect the exhaust duct to be sure that it has not become crushed or otherwise restricted.

RECOMMENDATIONS

Clothes dryer should not be exhausted into a chimney, a wall, a ceiling, or a concealed space of a building.
Local building codes shall be followed for installations.

Parts are covered by US patents: 5,121,948; 5,145,217; 5,133,579; 5,158,328; 5,498,204; 5,653,631; 5,819,435; 5,943,743; 6,035,495; 6,370,794; 6,390,510; D.335,174; D.342,130; D.342,782. Canadian patents 2,062,123; 2,063,098; 2,201,956; 2,279,599; 2,299,989; 2,317,863; Builder's Best, Inc., ® and/or patents pending. ©2014 all rights reserved