

LA600WH WIRED / WIRELESS DOOR CHIME

THIS PACKAGE INCLUDES:

- Wired / Wireless Door Chime with MP3 upload capability
- Decorative White Chime Cover
- USB Cable
- Mounting Hardware
- Pushbutton Diode (required for wired installation)

Door chime comes with eight pre-loaded sounds. Prior to installation, upload desired MP3 sound files.

1. Remove chime cover (B) from chime base (A). You may need to insert a finger into the large hole on the back of the chime base. (Figure 1)

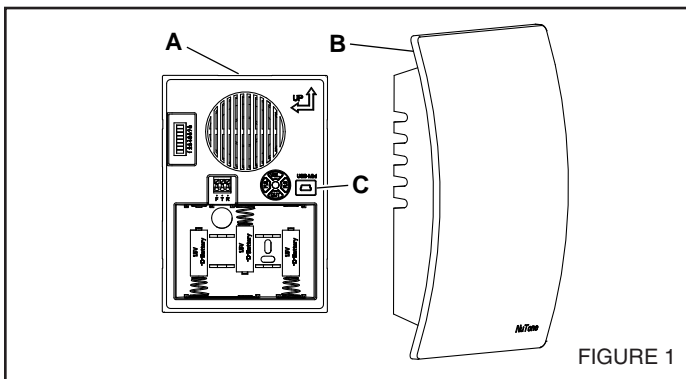

FIGURE 1

UPLOAD MP3 TUNES

1. Insert a USB Mini cable end into the doorbell mechanism USB jack (C). (Figure 1)
2. Insert the remaining larger USB cable end into a USB port on your computer.
3. On your **WINDOWS** computer,
 - Select "Start" in the bottom corner of your Desktop.
 - Select "My Computer"
 - Select the new device detected. (The drive "D.;" "E.;" etc. will vary from computer to computer).
 - Select the device.
 - You will now see a window that contains several mp3 files. These are the tunes that are pre-installed on your doorbell mechanism.
 - Search your computer for other mp3 songs that you wish to play on your doorbell mechanism when activated. Note: Files must be in mp3 format.
 - Once you have located those files, simply "COPY" the file and "PASTE" it into the folder that contains the pre-installed doorbell files.
 - Confirm that the transferred files are complete.
4. Remove USB cable and proceed to one of the following sections.

NEW WIRED CHIME INSTALLATION

WARNING



- **TO REDUCE THE RISK OF FIRE, ELECTRIC SHOCK, OR INJURY TO PERSONS, OBSERVE THE FOLLOWING:**

- Use this unit only in the manner intended by the manufacturer. If you have questions, contact the manufacturer at the address or telephone number listed in the warranty.
 - Before servicing or cleaning unit, switch power off at service panel and lock the service disconnecting means to prevent power from being switched on accidentally. When the service disconnecting means cannot be locked, securely fasten a prominent warning device, such as a tag, to the service panel.
 - Installation work and electrical wiring must be done by a qualified person(s) in accordance with all applicable codes and standards, including fire-rated construction codes and standards.
 - When cutting or drilling into wall or ceiling, do not damage electrical wiring and other hidden utilities.
 - Use NuTone® 16 volt transformer with a minimum rating of 10 VA (purchase separately).
 - When stapling wires to studs or joists, do not allow staples to cut through wire insulation.
1. Mount the transformer to a junction box (attic location is not recommended) or circuit breaker box.
 2. Connect house power leads to transformer leads: black to black, white to white, ground to green. (Figure 2)

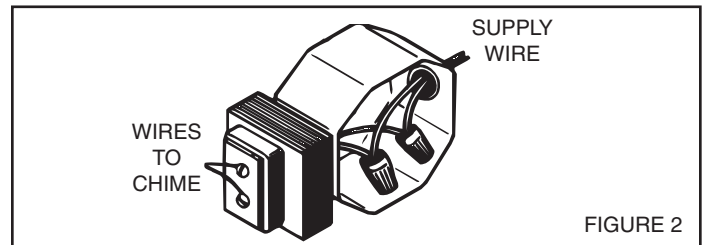

FIGURE 2

3. Route 2-conductor 18-22 gauge wire from the transformer screw terminals and from the pushbutton terminals to the chime location. (Figure 3)

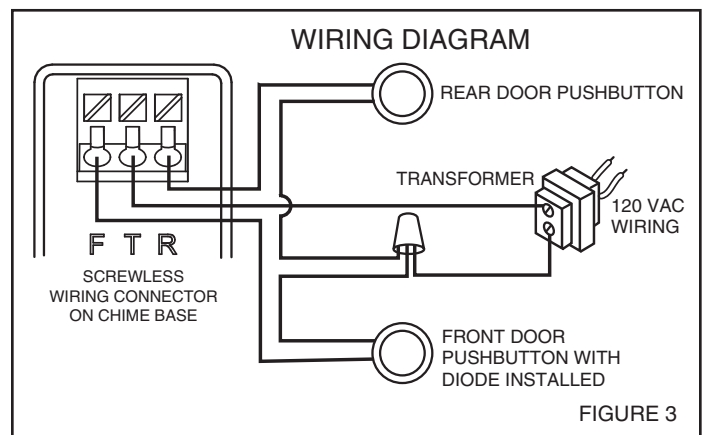
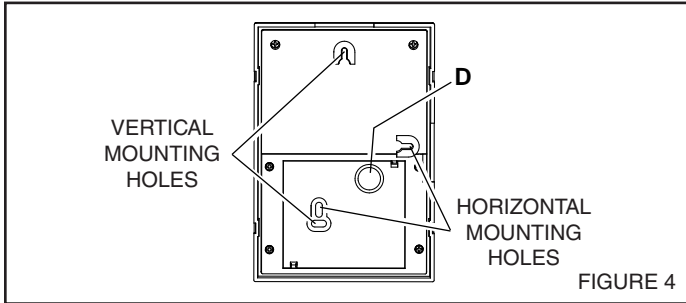

FIGURE 3

4. Label all wires at chime location in the following manner:

- "F" – Front Pushbutton Wire
- "T" – Transformer Wire
- "R" – Rear Pushbutton Wire (if installed)

- The chime can be installed vertically or horizontally. Determine your preferred orientation. Locate the arrows on the front of the chime base. Make sure one of the arrows is pointing up. (Figure 4)
- Bring wires through the circular wire hole (D) in chime base. (Figure 4)
- Mount chime base to wall using screws provided. Always use 2 screws for wall mounting. (Figure 4)



- Connect wires to the screwless wiring connector as follows: Wire "F" to connector terminal "F", wire "T" to connector terminal "T" and wire "R" to connector terminal "R" if installed. (Figure 3)
- Proceed to section titled: "INSTALL WIRED PUSHBUTTON"

EXISTING WIRED CHIME INSTALLATION

TURN OFF POWER AT SERVICE ENTRANCE.

- Verify a 16-volt transformer with a minimum rating of 10 VA is installed.
- Remove existing chime cover.
- Label all wires in the following manner:
 - "F" – Front Pushbutton Wire
 - "T" – Transformer Wire
 - "R" – Rear Pushbutton Wire (if installed)
- Disconnect all wires from existing chime base and remove from wall.
- Follow Steps 6 through 9 under section titled: "NEW WIRED INSTALLATION."

INSTALL WIRED PUSHBUTTONS

Power to transformer should be disconnected during pushbutton installation.

A diode must be added to the front door pushbutton so that power will be supplied continuously to the chime.

Do not install a diode on the rear door pushbutton.

- Locate the envelope containing the front door pushbutton diode. (Figure 5)

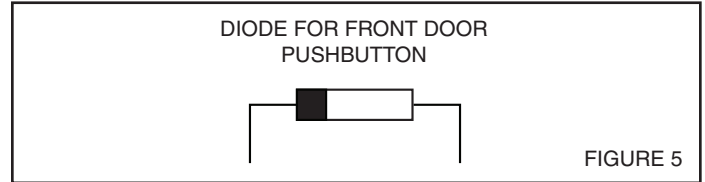

- If using an existing pushbutton(s), remove existing pushbutton(s) from wall. If installing new pushbutton(s), refer to installation instructions provided with pushbutton(s).
- Gently loosen pushbutton terminal screws and install diode from Step 1 on front door pushbutton only. (Figure 5) Wrap diode wires around terminals and clip excess wires. (Figure 6)

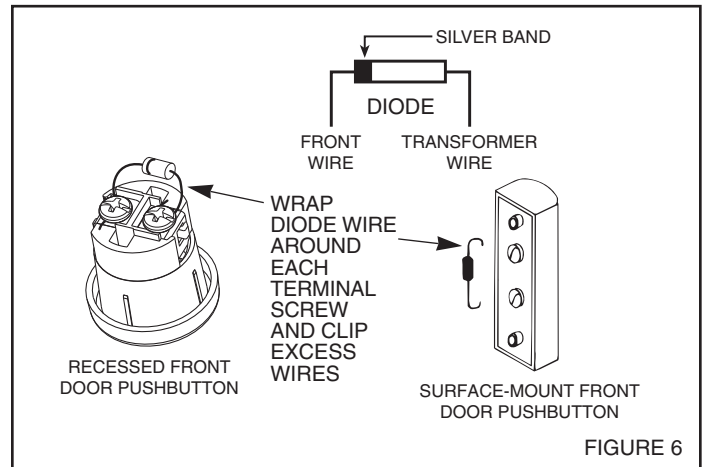

- Connect the chime wire to the front door pushbutton terminal closest to the silver band on the diode. Connect the transformer wire to the other terminal.
- Restore power to transformer.
- Press the pushbutton and listen for the chime to sound. If chime does not operate, disconnect power to transformer and reverse orientation of diode. Restore power to transformer.
- After confirming chime operates, follow steps under section titled "Manage Chime Notification" to select a tune, set tune duration, and set volume.
- Install pushbutton(s) on wall.
 - NOTE: To prevent shorting on metal siding, place a piece of insulating tape on the siding surface near the diode.
 - NOTE: Lighted pushbutton brightness will be reduced by 30%-40%. This is normal and will increase the life of the bulb.
- Place cover (B) over chime base (A) and press down to install. A "click" will confirm that it is securely attached. (Figure 1)
- Proceed to section titled: "Manage Chime Notifications"

WIRELESS CHIME INSTALLATION

Unobstructed wireless operating range: Up to 100 feet.

NOTE: Wireless pushbutton sold separately. Refer to installation instructions included with wireless pushbutton.

Keep batteries out of the reach of children.

1. Insert three alkaline "D" batteries (not included) (E) in battery compartment. Make sure batteries are oriented properly. (Figure 7)

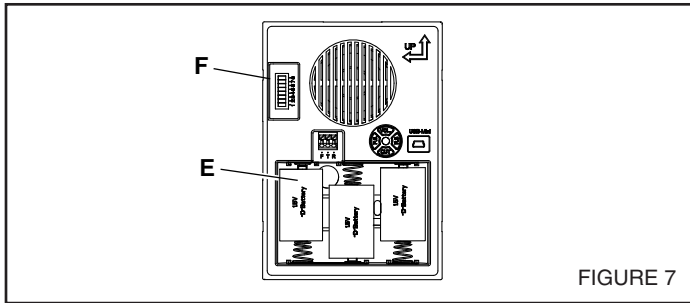

2. Obtain wireless pushbutton(s) (sold separately) and install battery per wireless pushbutton(s) instructions.
3. Press pushbutton(s) to confirm the chime mechanism and pushbutton(s) work properly. If the chime does not sound:
 - a. Confirm the code settings in the chime mechanism and wireless pushbutton(s) are the same. Jumpers (F) installed on the numbered contacts on the chime mechanism must match the switches or jumpers in the wireless pushbutton(s). (Figures 7 & 8)

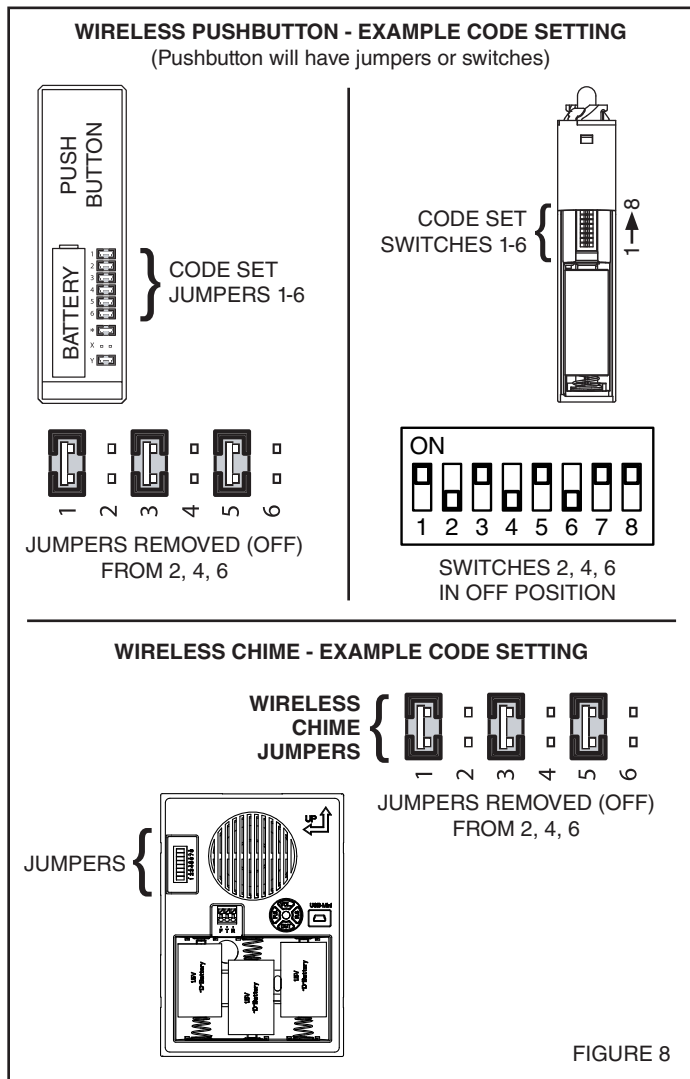

- b. Verify proper installation of batteries in chime mechanism and pushbutton(s).
 - c. Check condition of batteries in chime mechanism and pushbutton(s). Replace if required.
4. After confirming chime operates, follow steps under section titled "Manage Chime Notification" before proceeding to Step 5.
 5. If more than one pushbutton is being installed, refer to Figure 9 to assign doors.

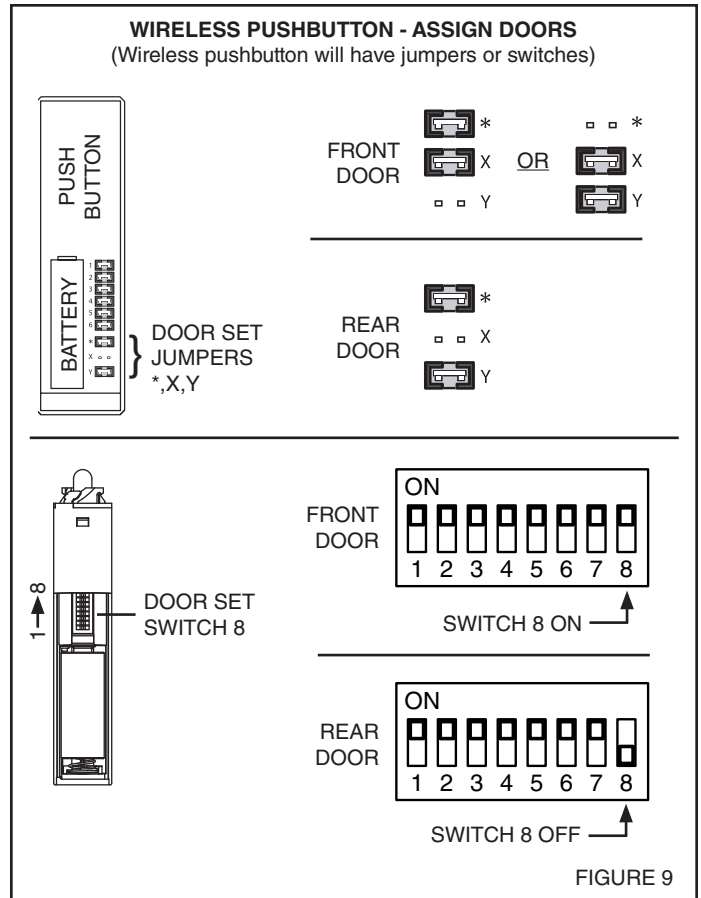

6. Install the wireless pushbutton(s) at the desired door(s). Refer to installation instructions provided with wireless pushbutton(s).
7. Place chime mechanism in desired location. Confirm operation by pressing pushbutton(s). If the chime does not sound:
 - a. The chime or pushbutton(s) are mounted on or near stucco or metal studs, the transmitter range may be reduced. Use wood shims to raise chime or pushbutton(s) 1/4" to 1/2" from surface.
 - b. Concrete floors and walls may also reduce transmitter range. Move chime away from concrete floor or wall.
 - c. Install chime mechanism closer to wireless pushbutton(s).
8. Remove batteries from mechanism.
9. Mount chime base to wall using screws provided (see Step 8 in "New Wired Chime Installation" section).
10. After mounting chime base to wall, install batteries.
11. Place cover (B) over chime base (A) and press down to install. A "click" will confirm that it is securely attached. (Figure 1).
12. Proceed to section titled: "Manage Chime Notification"

MANAGE CHIME NOTIFICATION

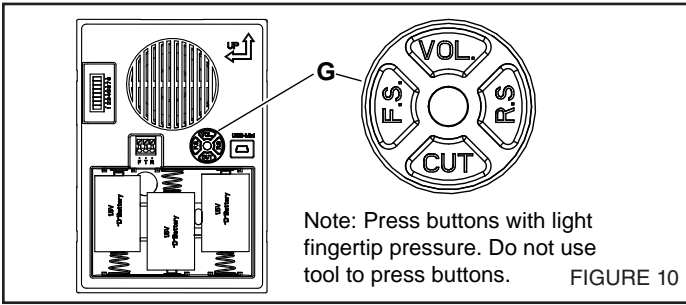

Select a Tune

The four button switch and indicator LED (G) on the chime are used to select the desired tunes for the chime. (Figure 10)

1. Make sure that the chime is powered (batteries or wiring).
2. Press “FS” button (Figure 10) one or more times to cycle through the tunes for the front door pushbutton. Do not press “FS” button after desired tune plays.
3. If rear door pushbutton is installed, press “RS” button (Figure 10) one or more times to cycle through the tunes for the rear door pushbutton. Do not press “RS” button after desired tune plays.

Set Tune Duration

1. Once the tune is selected, the time the tune plays can be adjusted to one of four durations:
 - Press the “CUT” button (Figure 10) one or more times to select the play time desired (5, 10, 20 seconds or the full song).
 - The desired play time is indicated by the LED indicator as outlined in the table below:

Length of Tune Played	Frequency of Flashing LED
5 sec.	Flashes once every second for 20 seconds.
10 sec.	Flashes 2 times, delays for 2 seconds, then repeats for 20 seconds.
20 sec.	Flashes 3 times, delays for 2 seconds, then repeats for 20 seconds.
Full Song Played	LED is illuminated continuously for 20 seconds.

Adjust volume

While the tune is playing, press “VOL” button (Figure 10) one or more times to cycle through three volume levels.

Regulatory Information

The user is cautioned that changes or modifications not expressly approved by the party responsible for regulatory compliance could void the user’s authority to operate this equipment.

This device complies with Part 15 of the FCC rules.

This device complies with RSS-210 of the Industrial Canada Rule.

Operation is subject to the following two conditions:

1. This device may not cause harmful interference, and
2. This device must accept any interference received, including interference that may cause undesired operation.

TROUBLESHOOTING GUIDE

SYMPTOM	SOLUTION
Rings once, then stops (wired chime).	1. Change diode orientation.
Ghost ringing (wired chime).	1. Open chime cover and change code with jumper(s).
Ghost ringing (wireless chime).	1. Open chime cover and change code with jumper(s). 2. Also change wireless pushbutton to match new code.
Poor sound quality	1. Quality of MP3 may be poor. 2. Decrease chime volume to reduce distortion.
No sound (wired chime).	1. Wire chime correctly. 2. Make sure transformer is the proper size. 3. Make sure diode orientation is correct. Press and hold pushbutton for 5 seconds and continue to hold, if the door chime rings after 5 seconds then the diode is connected backwards. If chime doesn't ring, check items 1 and 2.
No sound (wireless chime).	1. Make sure pushbutton battery orientation is correct. 2. Make sure pushbutton and chime frequency code match. 3. Make sure pushbutton is within range. 4. Make sure music was downloaded properly. a. Copy paste vs. drag and drop: i. Both should work, but copy paste is recommended. The more files, the longer the download may take. b. File format must be .mp3 c. Only works with Windows PC. Will not work with a Mac.