



#20308

Green Knob Compact Battery Switch

At 12 Volts: 125 Amps Continuous • 500 Surge

Top Mount Installation

1. Read CAUTION! before installing switch.
2. Remove existing cable from negative battery post and set aside.
3. Clean battery post for a good electrical contact.
4. Install battery switch to battery post and tighten.
5. Bolt the negative battery cable onto the "male" end of the battery disconnect switch and tighten.

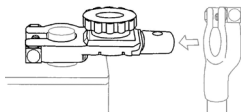

Side Mount Installation

1. Read CAUTION! before installing switch.
2. Remove existing cable from negative battery post and set aside.
3. Clean battery side "hook-up" port for a good electrical contact.
4. Install negative side-mount post adapter (purchased separately) to negative side of battery and tighten.
5. Attach battery switch to newly added side-mount post adapter and tighten.
6. Using a 1/4" x 1" bolt and nut (purchased separately), attach side mount battery cable to "male" end of battery disconnect switch and tighten.

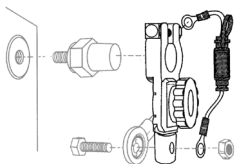

NOT APPROVED OR INTENDED FOR MARINE USE.

CAUTION!

Read this caution and all instructions thoroughly before installation. Batteries produce explosive gases and can explode! Wear eye protection; keep sparks, flame, cigarettes away from battery. Remember, batteries contain sulfuric acid. Wear safety glasses. In case of contact with skin, eyes, or clothing, flush immediately with large amounts of water and follow through with medical help. Do not use the switch while operating starter, as the battery load may become inductive as well as restrictive, causing an explosion if battery gases are present. Battery disconnects are for use only in well-ventilated environments.

THE USE OF THIS DISCONNECT IS TO CUT BATTERY POWER ON A VEHICLE—AFTER THE VEHICLE'S ENGINE IS TURNED OFF.

Try other fine
Battery Doctor® accessories!

**Top Mount
Battery
Disconnect
#20138**



WARNING! This product contains chemicals known to the State of California to cause cancer, or birth defects or other reproductive harm.